

45° E-Elbow

Agruline

AGRU Code: 170

MOP Water 16 bar / Gas 10 bar

Injection Moulded

Electrofusion

Available in PE100 Black

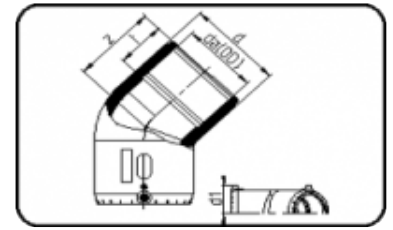

DIMENSION	CODE	DETAIL	da(O D) mm	z mm	d mm	d1 mm	t mm	WEIGHT
20	25170002 011	20 SDR 11/9/7.4	20	52	30	37	37.5	0.05
25	25170002 511	25 SDR 11/9/7.4	25	52	35	40	40.2	0.051
32	25170003 211	32 SDR 11/9/7.4	32	56	42	44	44	0.072
40	25170004 011	40 SDR 17/13.6/11/9/ 7.4	40	63	53	48	49	0.119
50	25170005 011	50 SDR 17/13.6/11/9/ 7.4	50	70	67	53	55	0.2
63	25170006 311	63 SDR 17/13.6/11/9/ 7.4	63	82	82.5	58.5	62.7	0.327
75	25170007 511	75 SDR 17/13.6/11/9/ 7.4	75	94	97	66	70	0.5
90	25170009 011	90 SDR 17/13.6/11/9/ 7.4	90	113	115	74	71	0.89

110	25170011 011	110 SDR 17/13.6/11/9/ 7.4	110	12 4	140	82.5	72	1.43
125	25170012 511	125 SDR 17/13.6/11/9/ 7.4	125	12 4	161	92	86	1.83
160	25170016 011	160 SDR 17/13.6/11/9/ 7.4	160	16 4	200	112	89	3.56
180	25170018 011	180 SDR 26/17/13.6/1 1/9/7.4	180	172	224	119	99	4.89
200	25170020 011	200 SDR 26/17/13.6/1 1/9/7.4	200	178	248. 5	130. 5	106. 5	6
225	25170022 511	225 SDR 26/17/13.6/1 1/9/7.4	225	19 0	279	145. 5	113. 5	7.99

90° E-Elbow

Agruline

AGRU Code: 171

MOP Water 16 bar / Gas 10 bar

Injection Moulded

Electrofusion

Available in PE100 Black

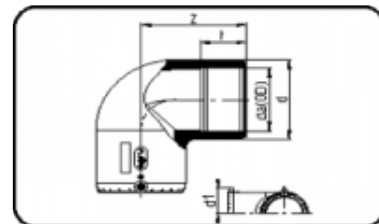

DIMENSI ON	CODE	DETAIL	da(O D) mm	z m m	d m m	d1 mm	t mm	WEIGH T
20	25171002 011	20 SDR 11/9/7.4	20	58	30	37	37.5	0.054
25	25171002 511	25 SDR 11/9/7.4	25	61	35	40	40. 3	0.061

32	25171003 211	32 SDR 11/9/7.4	32	65	42	44	44	0.078
40	25171004 011	40 SDR 17/13.6/11/9/7. 4	40	75	53	49	49	0.138
50	25171005 011	50 SDR 17/13.6/11/9/7. 4	50	85	67	53	55	0.236
63	25171006 311	63 SDR 17/13.6/11/9/7. 4	63	99	83	60	62.7	0.392
75	25171007 511	75 SDR 17/13.6/11/9/7. 4	75	114	97	66	70	0.607
90	25171009 011	90 SDR 17/13.6/11/9/7. 4	90	147	114	73	70.5	1.09
110	251710110 11	110 SDR 17/13.6/11/9/7. 4	110	16 4	14 0	82. 5	71.5	1.8
125	251710125 11	125 SDR 17/13.6/11/9/ 7.4	125	16 4	161	91	84	2.4
160	251710160 11	160 SDR 17/13.6/11/9/ 7.4	160	22 2	20 0	109	87	4.7
180	25171018 011	180 SDR 26/17/13.6/1 1/9/7.4	180	23 0	22 4	118	98. 5	6.25
225	25171022 511	225 SDR 26/17/13.6/1 1/9/7.4	225	27 4	27 9	144	112. 5	10.8

Brass – R – Female Thread – For E-Adaptor Agruline

AGRU Code: 180

Injection Moulded

Electrofusion

Available in PE100 Black

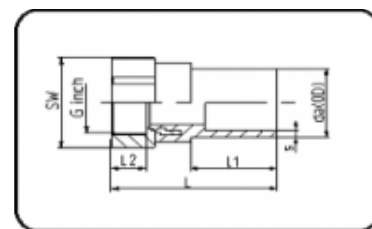

DIMENSION	CODE	DETAIL	da (OD) mm	s mm	L mm	L1 mm	L2 mm	S W mm	G mm	K mm	E mm	WEIGHT
20 X 1/2	25180 00201 1	20X1/2" SDR 11	20	3	76	40	27	32	0.5	18.63	20.96	0.127
25 X 3/4	25180 00251 1	25X3/4" SDR 11	25	3	80	43	28	36	0.75	24.12	26.44	0.151
32 X 1	25180 00321 1	32X1" SDR 11	32	3	88	46	34	41	1	30.29	33.25	0.197
40 X 1 1/4	25180 00401 1	40X1 1/4" SDR 11	40	3.7	98	51	36	50	1.25	38.95	41.91	0.295
50 X 1 1/2	25180 00501 1	50X1 1/2" SDR 11	50	4.6	110	57	43	60	1.5	44.85	47.8	0.525
63 X 2	25180 00631 1	63X2" SDR 11	63	5.8	129	65	52	70	2	56.66	59.61	0.768

Brass – R – Male Thread – For E-Adaptor

Agruline

AGRU Code: 181

Injection Moulded

Electrofusion

Available in PE100 Black

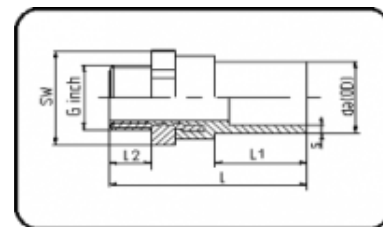

DIMENSION	CODE	DETAIL	da (OD) mm	s mm	L mm	L1 mm	L2 mm	S mm	G mm	K mm	E mm	WEIGHT
20 X 1/2	25181 00201 1	20X1/2" SDR 11	20	3	81	40	16	32	0.5	18.63	20.96	0.103
25 X 3/4	25181 00251 1	25X3/4" SDR 11	25	3	85	43	16	36	0.75	24.12	26.44	0.133
32 X 1/2	25181 20321 1	32X1/2" SDR 11	32	3	88	46	16.5	41	0.5	18.63	33.25	0.195
32 X 3/4	25181 25321 1	32X3/4" SDR 11	32	3	90	46	18	41	0.75	30.29	33.25	0.187
32 X 1	25181 00321 1	32X1" SDR 11	32	3	92	46	19	41	1	30.29	33.25	0.185
32 X 1 1/4	25181 40321 1	32X1 1/4" SDR 11	32	3	95	46	23	41	1.25	30.29	33.25	0.3
32 X 1 1/2	25181 50321 1	32X1 1/2" SDR 11	32	3	97	46	25	41	1.5	30.29	33.25	0.49
40 X 1	25181 32401 1	40X1" SDR 11	40	3.7	99	51	21	50	1	38.95	41.91	0.29

40 X 1 1/4	25181 0040 11	40X1 1/ 4" SDR 11	40	3. 7	10 0	51	21	50	1.2 5	38. 95	41. 91	0.26 9
40 X 1 1/2	25181 50401 1	40X1 1/ 2" SDR 11	40	3. 7	10 3	51	25	50	1.5	38. 95	41. 91	0.4
40 X 2	25181 63401 1	40X2" S DR 11	40	3. 7	10 7	51	29	50	2	38. 95	41. 91	0.76
50 X 1	25181 32501 1	50X1" S DR 11	50	4. 6	10 5	57	21	60	1	44. 85	47. 8	0.42
50 X 1 1/4	25181 40501 1	50X1 1/ 4" SDR 11	50	4. 6	10 7	57	22	60	1.2 5	44. 85	47. 8	0.42 7
50 X 1 1/2	25181 0050 11	50X1 1/ 2" SDR 11	50	4. 6	10 9	57	23	60	1.5	44. 85	47. 8	0.38
50 X 2	25181 63501 1	50X2" S DR 11	50	4. 6	11 4	57	29	60	2	44. 85	47. 8	0.68
63 X 1 1/4	25181 40631 1	63X1 1/ 4" SDR 11	63	5. 8	11 7	65	21	70	1.2 5	56. 66	59. 61	0.65 1
63 X 1 1/2	25181 50631 1	63X1 1/ 2" SDR 11	63	5. 8	12 1	65	25	70	1.5	56. 66	59. 61	0.61 7
63 X 2	25181 00631 1	63X2" S DR 11	63	5. 8	12 4	65	27	70	2	56. 66	59. 61	0.57 3

Concrete Connection Socket – SAM

Agruline

AGRU Code: 178.1

With Assembled Puddle Flange

Machines

Electrofusion

Available in PE100 Black

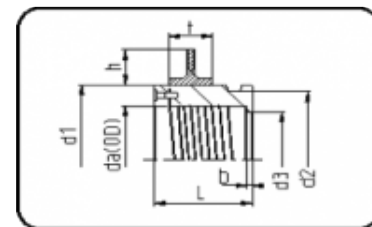

DIMENSION	CODE	DETAIL	da (OD) mm	L m m	d1 m m	d2 m m	d3 m m	h m m	b m m	t m m	WEIGHT
160	251781 16033	160 SDR 3 3/26/17/11	160	13 5	19 7	18 4	15 1	50	8	60	2.14
225	251781 22533	225 SDR 3 3/26/17/11	225	13 5	27 2	25 7	21 2	50	8	60	3.38
280	251781 28033	280 SDR 3 3/26/17/11	280	13 5	34 5	33 0	26 4	50	8	60	5.2
355	251781 35533	355 SDR 3 3/26/17/11	355	13 5	44 0	42 5	33 8	37. 5	8	75	8.6
450	251781 45033	450 SDR 3 3/26/17/11	450	13 5	49 4	48 0	43 0	37. 5	8	75	6.8
560	251781 56033	560 SDR 3 3/26/17/11	560	13 5	62 0	60 6	54 0	37. 5	8	75	9.22

Concrete Connection Socket TYP2

Agruline

AGRU Code: 178.2

With assembled puddle flange

Machined

Electrofusion

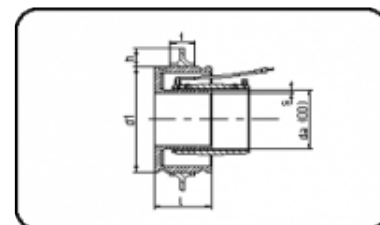

Available in PE100 Black

DIMENSION	CODE	DETAIL	da(O D) mm	L mm	d1 mm	h mm	s mm	t mm	WEIGHT
110	25178211017	110 SDR 33-17	110	135	216	50	6.6	60	3.6
125	25178212517	125 SDR 33-17	125	135	216	50	7.4	60	4.46
160	25178216017	160 SDR 33-17	160	135	280	50	9.5	60	5.6
180	25178218017	180 SDR 33-17	180	135	310	50	10.7	60	7.6
200	25178220017	200 SDR 33-17	200	135	312	50	11.9	60	6.338
225	25178225517	225 SDR 33-17	225	135	355	50	13.4	60	9.4
250	25178225017	250 SDR 33-17	250	135	375	37.5	14.8	75	11.2
280	25178228017	280 SDR 33-17	280	135	420	37.5	16.6	75	12.125
315	25178231517	315 SDR 33-17	315	135	460	37.5	18.7	75	17.9
355	25178235517	355 SDR 33-17	355	135	480	37.5	21.1	75	18.001
400	25178240017	400 SDR 33-17	400	135	550	37.5	23.7	75	26.4

E-Adapter Socket – Brass – Female

Agruline

AGRU Code: 184

Injection Moulded

Electrofusion

Available in PE100 Black

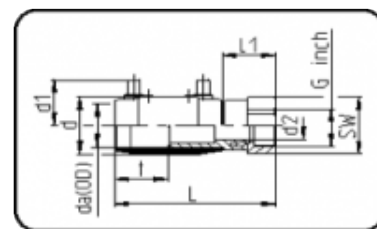

DIMENSION	CODE	DETAIL	da (OD) mm	L mm	L1 mm	d mm	d1 mm	d2 mm	S mm	t mm	G mm	K mm	E mm	WEIGHT
20 X 1/2	25184202011	20X 1/2" SDR 11	20	111	37	30	34	12	32	37	0.5	18.63	20.96	0.158
25 X 3/4	25184252511	25X 3/4" SDR 11	25	121	40	35	37	16	36	40	0.75	24.12	26.44	0.194
32 X 1	25184323211	32X 1" SDR 11	32	133	44	42	40	21	41	44	1	30.29	33.25	0.252
40 X 1 1/4	25184404011	40X1 1/4" SDR 17/11	40	148	49	53	44	27.5	50	49	1.25	38.95	41.91	0.381
50 X 1 1/2	25184505011	50X1 1/2" SDR 17/11	50	167	56	67	49	35.5	60	55	1.5	44.85	47.8	0.686

63	251	63X	63	19	67	8	5	4	7	6	2	5	5	1
X 2	84	2" SD		4		3	6	2	0	3		6.	9.	
	63	R 17/										66	61	
	631	11												
	1													

E-Adapter Socket – Brass – Male

Agruline

AGRU Code: 185

Injection Moulded

Electrofusion

Available in PE100 Black

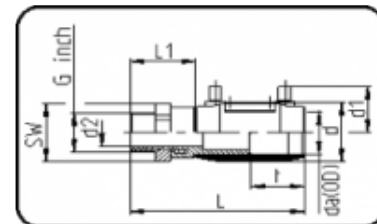

DIM EN SIO N	CO DE	DET AIL	da (O D) m m	L m m	L1 m m	d m m	d 1 m m	d 2 m m	S W m m	t m m	G m m	K m m	E m m	WE IG HT
20 X 1/ 2	251 85 20 201 1	20X 1/2" SDR 11	20	12 0	4 5	3 0	3 4	12	3 2	3 7	0. 5	1 8. 63	2 0. 96	0.1 36
25 X 3/4	251 85 252 511	25X 3/4" SDR 11	25	12 7	4 6	3 5	3 7	16	3 6	4 0	0. 75	2 4.1 2	2 6. 44	0.1 75
32 X 1/ 2	251 85 20 321 1	32X 1/2" SDR 11	32	13 2	4 3	4 2	4 3	12	41	4 4	0. 5	1 8. 63	2 0. 96	0.2 44

32 X 3/4	251 85 253 211	32X 3/4" SDR 11	32	13 3	4 4	4 2	4 3	16	41	4 4	0. 75	2 4.1 2	2 0. 96	0.2 43
32 X 1	251 85 32 321 1	32X1" SDR 11	32	13 8	4 9	4 2	4 0	21	41	4 4	1	3 0. 29	3 3. 25	0.2 38
32 X 1 1/4	251 85 40 321 1	32X1 1/4" SDR 11	32	13 8	4 9	4 2	4 3	21	4 6	4 4	1. 2 5	3 8. 95	2 0. 96	0. 37
32 X 1 1/2	251 85 50 321 1	32X1 1/2" SDR 11	32	14 0	51	4 2	4 3	21	5 5	4 4	1. 5	4 4. 85	2 0. 96	0.5 45
40 X 1	251 85 32 401 1	40X 1" SD R 17/ 11	40	14 7	4 8	5 3	4 7	21	5 0	4 9	1	3 0. 29	2 0. 96	0. 37 9
40 X 1 1/4	251 85 40 401 1	40X1 1/4" SDR 17/11	40	15 1	5 2	5 3	4 4	2 7. 5	5 0	4 9	1. 2 5	3 8. 95	4 1.9 1	0. 35 4
40 X 1 1/2	251 85 50 401 1	40X1 1/2" SDR 17/11	40	15 1	5 2	5 3	4 7	2 8	5 5	4 9	1. 5	4 4. 85	2 0. 96	0. 49 3

40 X 2	251 85 63 401 1	40X 2" SD R 17/ 11	40	15 5	5 6	5 3	4 7	2 8	6 5	4 9	2	5 6. 66	2 0. 96	0. 85 1
50 X 1	251 85 325 011	50X 1" SD R 17/ 11	50	15 9	4 8	67	5 3	21	6 0	5 5	1	3 0. 29	2 0. 96	0.5 99
50 X 1 1/4	251 85 40 501 1	50X1 1/4" SDR 17/11	50	16 2	51	67	5 3	2 8	6 0	5 5	1. 2 5	3 8. 95	2 0. 96	0.5 7
50 X 1 1/2	251 85 50 501 1	50X1 1/2" SDR 17/11	50	16 6	5 5	67	4 9	3 3. 5	6 0	5 5	1. 5	4 4. 85	4 7. 8	0.5 29
50 X 2	251 85 63 501 1	50X 2" SD R 17/ 11	50	16 8	5 7	67	5 3	3 4	6 5	5 5	2	1 8. 63	2 0. 96	0. 82 7
63 X 1 1/4	251 85 40 631 1	63X1 1/4" SDR 17/11	63	17 9	5 2	8 3	6 0	2 8	7 0	6 3	1. 2 5	3 8. 95	2 0. 96	0.9
63 X 1 1/2	251 85 50 631 1	63X1 1/2" SDR 17/11	63	18 3	5 6	8 3	6 0	3 4	7 0	6 3	1. 5	4 4. 85	2 0. 96	0. 83

63	251	63X	63	18	6	8	5	4	7	6	2	5	5	0.
X 2	85	2" SD		9	2	3	6	2	0	3		6.	9.	82
	63	R 17/										66	61	5
	631	11												
	1													

E-Adapter Socket – Steel – Female

Agruline

AGRU Code: 184.1

Injection Moulded

Electrofusion

Available in PE100 Black

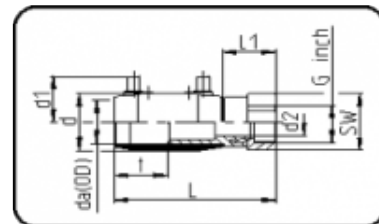

DIM EN SIO N	CO DE	DET AIL	da (O D) m m	L m m	L1 m m	d m m	d 1 m m	d 2 m m	S W m m	t m m	G m m	K m m	E m m	WE IG HT
20 X 1/ 2	251 84 20 211 1	20X 1/2" SDR 11	20	11 1	3 7	3 0	3 4	12	3 2	3 7	0. 5	1 8. 63	2 0. 96	0.1 5
25 X 3/4	251 84 252 611	25X 3/4" SDR 11	25	12 1	4 0	3 5	3 7	16	3 6	4 0	0. 75	2 4.1 2	2 6. 44	0.1 82
32 X 1	251 84 32 331 1	32X1" SDR 11	32	13 3	4 4	4 2	4 0	21	41	4 4	1	3 0. 29	3 3. 25	0.2 4

40 X 1 1/4	251 84 40 411 1	40X1 1/4" SDR 17/11	40	14 8	4 9	5 3	4 4	2 7. 5	5 0	4 9	1. 2 5	3 8. 95	4 1.9 1	0.5 7
50 X 1 1/2	251 84 50 511 1	50X1 1/2" SDR 17/11	50	16 7	5 6	67	4 9	3 3. 5	6 0	5 5	1. 5 5	4 4. 85	4 7. 8	0.6 5
63 X 2	251 84 63 641 1	63X 2" SD R 17/ 11	63	19 4	67	8 3	5 6	4 2	7 0	6 3	2	5 6. 66	5 9. 61	0.9 66

E-Adapter Socket – Steel – Male

Agruline

AGRU Code: 185.1

Injection Moulded

Electrofusion

Available in PE100 Black

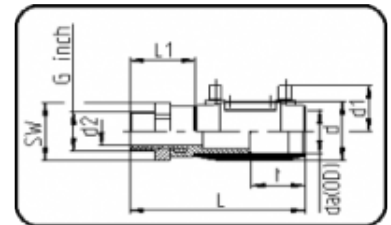

DIM EN SIO N	CO DE	DET AIL	da (O D) m m	L m m	L1 m m	d m m	d 1 m m	d 2 m m	S W m m	t m m	G m m	K m m	E m m	WE IG HT
20 X 1/ 2	251 85 20 211 1	20X 1/2" SDR 11	20	12 0	4 5	3 0	3 4	12	3 2	3 7	0. 5	1 8. 63	2 0. 96	0. 01 3

25 X 3/4	251 85 252 611	25X 3/4" SDR 11	25	12 7	4 6	3 5	3 7	16	3 6	4 0	0. 75	2 4.1 2	2 6. 44	0.1 7
32 X 1	251 85 32 331 1	32X1" SDR 11	32	13 8	4 9	4 2	4 0	21	41	4 4	1	3 0. 29	3 3. 25	0.2 26
40 X 1 1/4	251 85 40 411 1	40X1 1/4" SDR 17/11	40	15 1	5 2	5 3	4 4	2 7. 5	5 0	4 9	1. 2 5	3 8. 95	4 1.9 1	0. 34 2
50 X 1 1/2	251 85 50 511 1	50X1 1/2" SDR 17/11	50	16 6	5 5	67	4 9	3 3. 5	6 0	5 5	1. 5 5	4 4. 85	4 7. 8	0.5 07
63 X 2	251 85 63 641 1	63X 2" SD R 17/ 11	63	18 9	6 2	8 3	5 6	4 2	7 0	6 3	2	5 6. 66	5 9. 61	0.7 94

E-Adaptor Elbow 45° – Brass – Female Thread

Agruline

AGRU Code: 189

Injection Moulded

Electrofusion

Available in PE100 Black

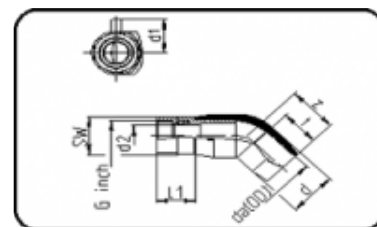

DIMENSION	CODE	DETAIL	da (OD) mm	L mm	L1 mm	d mm	d1 mm	d2 mm	S mm	t mm	G mm	K mm	E mm	WEIGHT
20 X 1/2	25189202011	20X 1/2" SDR 11	20	52	36	30	34	12	32	37	0.5	18.63	20.96	0.16
25 X 3/4	25189252511	25X 3/4" SDR 11	25	52	40	35	37	16	36	40	0.75	24.12	26.44	0.202
32 X 1	25189323211	32X1" SDR 11	32	56	44	42	40	21	41	44	1	30.29	33.25	0.27
40 X 1 1/4	25189404011	40X1 1/4" SDR 17/11	40	63	49	53	44	27.5	50	49	1.25	38.95	41.91	0.43
50 X 1 1/2	25189505011	50X1 1/2" SDR 17/11	50	70	56	67	49	33.5	60	55	1.5	44.85	47.8	0.6
63 X 2	25189636311	63X 2" SD R 17/11	63	82	67	83	56	42	70	63	2	56.66	59.61	1.15

E-Adaptor Elbow 45° – Brass – Male Thread

Agruline

AGRU Code: 188

Injection Moulded

Electrofusion

Available in PE100 Black

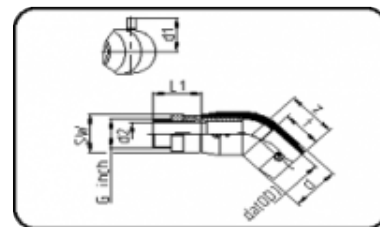

DIMENSION	CODE	DETAIL	da (OD) mm	L mm	L1 mm	d mm	d1 mm	d2 mm	S mm	t mm	G mm	K mm	E mm	WEIGHT
20 X 1/2	25188202011	20X 1/2" SDR 11	20	52	45	30	34	12	32	37	0.5	18.63	20.96	0.149
25 X 3/4	25188252511	25X 3/4" SDR 11	25	52	46	35	37	16	36	40	0.75	24.12	26.44	0.18
32 X 1	25188323211	32X 1" SDR 11	32	56	49	42	40	21	41	44	1	30.29	33.25	0.26
40 X 1 1/4	25188404011	40X1 1/4" SDR 17/11	40	63	52	53	44	27.5	50	49	1.25	38.95	41.91	0.4
50 X 1 1/2	25188505011	50X1 1/2" SDR 17/11	50	70	55	67	49	33.5	60	55	1.5	44.85	47.8	0.572

63	251	63X	63	8	6	8	5	4	7	6	2	5	5	0.9
X 2	88	2" SD		2	2	3	6	2	0	3		6.	9.	03
	63	R 17/										66	61	
	631	11												
	1													

E-Adaptor Elbow 45° – Steel – Female Thread

Agruline

AGRU Code: 189.1

Injection Moulded

Electrofusion

Available in PE100 Black

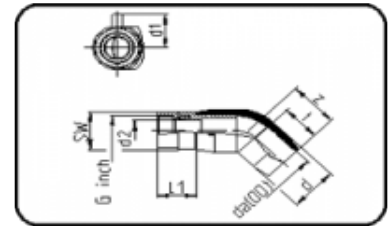

DIM EN SIO N	CO DE	DET AIL	da (O D) m m	L m m	L1 m m	d m m	d 1 m m	d 2 m m	S W m m	t m m	G m m	K m m	E m m	WE IG HT
20 X 1/ 2	251 89 20 211 1	20X 1/2" SDR 11	20	5 2	3 6	3 0	3 4	12	3 2	3 7	0. 5	1 8. 63	2 0. 96	0.1 6
25 X 3/4	251 89 25 261 1	25X 3/4" SDR 11	25	5 2	4 0	3 5	3 7	16	3 6	4 0	0. 75	2 4.1 2	2 6. 44	0.2
32 X 1	251 89 32 331 1	32X1" SDR 11	32	5 6	4 4	4 2	4 0	21	41	4 4	1	3 0. 29	3 3. 25	0.2 7

40 X 1 1/4	251 89 40 411 1	40X1 1/4" SDR 17/11	40	6 3	4 9	5 3	4 4	2 7. 5	5 0	4 9	1. 2 5	3 8. 95	4 1.9 1	0. 43
50 X 1 1/2	251 89 50 511 1	50X1 1/2" SDR 17/11	50	7 0	5 6	67	4 9	3 3. 5	6 0	5 5	1. 5	4 4. 85	4 7. 8	0.6
63 X 2	251 89 63 641 1	63X 2" SD R 17/ 11	63	8 2	67	8 3	5 6	4 2	7 0	6 3	2	5 6. 66	5 9. 61	1.1 5

E-Adaptor Elbow 45° – Steel – Male Thread

Agruline

AGRU Code: 188.1

Injection Moulded

Electrofusion

Available in PE100 Black

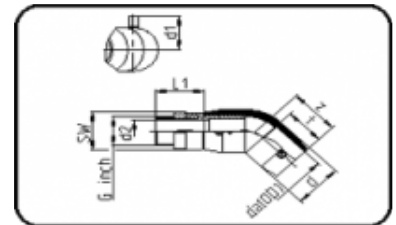

DIM EN SIO N	CO DE	DET AIL	da (O D) m m	L m m	L1 m m	d m m	d 1 m m	d 2 m m	S W m m	t m m	G m m	K m m	E m m	WE IG HT
20 X 1/ 2	251 88 20 211 1	20X 1/2" SDR 11	20	5 2	4 5	3 0	3 4	12	3 2	3 7	0. 5	1 8. 63	2 0. 96	0.1 6

25 X 3/4	251 88 252 611	25X 3/4" SDR 11	25	5 2	4 6	3 5	3 7	16	3 6	4 0	0. 75	2 4.1 2	2 6. 44	0.1 8
32 X 1	251 88 32 331 1	32X1" SDR 11	32	5 6	4 9	4 2	4 0	21	41	4 4	1	3 0. 29	3 3. 25	0.2 6
40 X 1 1/4	251 88 40 411 1	40X1 1/4" SDR 17/11	40	6 3	5 2	5 3	4 4	2 7. 5	5 0	4 9	1. 2 5	3 8. 95	4 1.9 1	0. 4
50 X 1 1/2	251 88 50 511 1	50X1 1/2" SDR 17/11	50	7 0	5 5	67	4 9	3 3. 5	6 0	5 5	1. 5	4 4. 85	4 7. 8	0.6 2
63 X 2	251 88 63 641 1	63X 2" SD R 17/ 11	63	8 2	6 2	8 3	5 6	4 2	7 0	6 3	2	5 6. 66	5 9. 61	0.9 8

E-Adaptor Elbow 90° – Brass – Female Thread

Agruline

AGRU Code: 187

Injection Moulded

Electrofusion

Available in PE100 Black

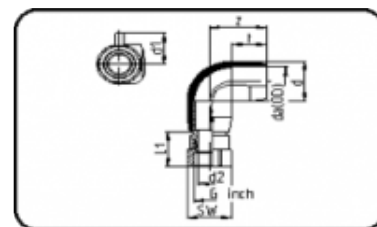

DIMENSION	CODE	DETAIL	da (OD) mm	L mm	L1 mm	d mm	d1 mm	d2 mm	S mm	t mm	G mm	K mm	E mm	WEIGHT
20X1/2	25187202011	20X 1/2" SDR 11	20	58	36	30	34	12	32	37	0.5	18.63	20.96	0.177
25X3/4	25187252511	25X 3/4" SDR 11	25	61	40	35	37	16	36	40	0.75	24.12	26.44	0.215
32X1	25187323211	32X1" SDR 11	32	65	44	42	40	21	41	44	1	30.29	33.25	0.276
40X1 1/4	25187404011	40X1 1/4" SDR 17/11	40	75	49	53	44	27.5	50	49	1.25	38.95	41.91	0.427
50X1 1/2	25187505011	50X1 1/2" SDR 17/11	50	85	56	67	49	33.5	60	55	1.5	44.85	47.8	0.775
63X2	25187636311	63X 2" SD R 17/11	63	100	67	83	56	42	70	63	2	56.66	59.61	1.16

E-Adaptor Elbow 90° – Brass – Male Thread

Agruline

AGRU Code: 186

Injection Moulded

Electrofusion

Available in PE100 Black

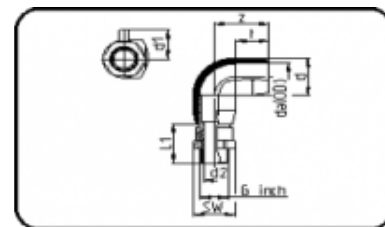

DIMENSION	CODE	DETAIL	da (OD) mm	L mm	L1 mm	d mm	d1 mm	d2 mm	S mm	t mm	G mm	K mm	E mm	WEIGHT
20 X 1/2	25186202011	20X 1/2" SDR 11	20	58	45	30	34	12	32	37	0.5	18.63	20.96	0.155
25 X 3/4	25186252511	25X 3/4" SDR 11	25	61	46	35	37	16	36	40	0.75	24.12	26.44	0.196
32 X 1	25186323211	32X 1" SD R 11	32	65	49	42	40	21	41	44	1	30.29	33.25	0.265
40 X 1 1/4	25186404011	40X 1 1/4" SDR 17/11	40	75	52	53	44	27.5	50	49	1.25	38.95	41.9	0.412
50 X 1 1/2	25186505011	50X 1 1/2" SDR 17/11	50	85	55	67	49	35.5	60	55	1.5	44.85	47.8	0.617

63 X 2	251 86 63 631 1	63X 2" SD R 17/ 11	63	10 0	6 2	8 3	5 6	4 2	7 0	6 3	2	5 6. 66	5 9. 61	0.9 66
-----------	-----------------------------	-----------------------------	----	---------	--------	--------	--------	--------	--------	--------	---	---------------	---------------	-----------

E-Adaptor Elbow 90° – Steel – Female Thread

Agruline

AGRU Code: 187.1

Injection Moulded

Electrofusion

Available in PE100 Black

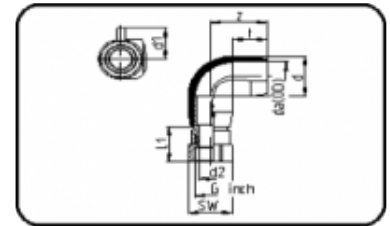

DIM EN SIO N	CO DE	DET AIL	da (O D) m m	L m m	L1 m m	d m m	d 1 m m	d 2 m m	S W m m	t m m	G m m	K m m	E m m	WE IG HT
20 X 1/ 2	251 872 021 11	20X 1/2" SDR 11	20	5 8	3 6	3 0	3 4	12	3 2	3 7	0. 5	1 8. 63	2 0. 96	0.1 7
25 X 3/4	251 872 52 611	25X 3/4" SDR 11	25	61	4 0	3 5	3 7	16	3 6	4 0	0. 75	2 4.1 2	2 6. 44	0.2
32 X 1	251 873 23 311	32X1" SDR 11	32	6 5	4 4	4 2	4 0	21	41	4 4	1	3 0. 29	3 3. 25	0.2 62
40 X 1 1/4	251 874 041 11	40X1 1/4" SDR 17/11	40	7 5	4 9	5 3	4 4	2 7. 5	5 0	4 9	1. 2 5	3 8. 95	4 1.9 1	0. 41

50 X 1 1/2	251 875 051 11	50X1 1/2" SDR 17/11	50	8 5	5 6	67	4 9	3 3. 5	6 0	5 5	1. 5	4 4. 85	4 7. 8	0.7 4
63 X 2	251 876 36 411	63X 2" SD R 17/ 11	63	10 0	67	8 3	5 6	4 2	7 0	6 3	2	5 6. 66	5 9. 61	1.1 2

E-Adaptor Elbow 90° – Steel – Male Thread

Agruline

AGRU Code: 186.1

Injection Moulded

Electrofusion

Available in PE100 Black

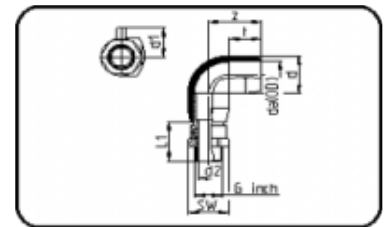

DIM EN SIO N	CO DE	DET AIL	da (O D) m m	L m m	L1 m m	d m m	d 1 m m	d 2 m m	S W m m	t m m	G m m	K m m	E m m	WE IG HT
20 X 1/ 2	251 86 20 211 1	20X 1/2" SDR 11	20	5 8	4 5	3 0	3 4	12	3 2	3 7	0. 5	1 8. 63	2 0. 96	0.1 6
25 X 3/4	251 86 252 611	25X 3/4" SDR 11	25	61	4 6	3 5	3 7	16	3 6	4 0	0. 75	2 4.1 2	2 6. 44	0.1 8
32 X 1	251 86 32 331 1	32X1" SDR 11	32	6 5	4 9	4 2	4 0	21	41	4 4	1	3 0. 29	3 3. 25	0.2 5

40 X 1 1/4	251 86 40 411 1	40X1 1/4" SDR 17/11	40	7 5	5 2	5 3	4 4	2 7. 5	5 0	4 9	1. 2 5	3 8. 95	4 1.9 1	0. 39 6
50 X 1 1/2	251 86 50 511 1	50X1 1/2" SDR 17/11	50	8 5	5 5	67 3	4 9	3 3. 5	6 0	5 5	1. 5 5	4 4. 85	4 7. 8	0.5 96
63 X 2	251 86 63 641 1	63X 2" SD R 17/ 11	63	10 0	6 2	8 3	5 6	4 2	7 0	6 3	2	5 6. 66	5 9. 61	0.9 4

E-Coupler – 10 Bar / Gas 6 Bar

Agruline

AGRU Code: 173

MOP Water 10 bar / Gas 6 bar

Injection Moulded

Electrofusion

Available in PE100 Black

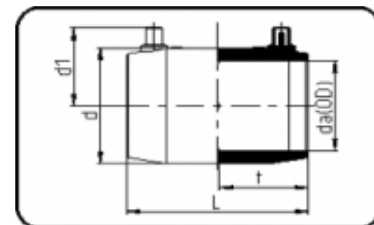

DIMENSIO N	CODE	DETAIL	da(0) D) mm	L m m	d m m	d1 mm	t mm	WEIGH T
90	2517300901 7	90 SDR 33-17	90	141	109	74	69	0.331
110	25173011017	110 SDR 33-17	110	152	133	82	75	0.572
160	2517301601 7	160 SDR 33-1 7	160	181	188	107.5	89.5	1.085

200	2517302001 7	200 SDR 33-1 7	200	217	23 4	127	106. 5	2.01
225	2517302251 7	225 SDR 33-1 7	225	232	26 3	144	113.5	2.8
250	2517302501 7	250 SDR 33-1 7	250	242	293	152.5	120	4
280	2517302801 7	280 SDR 33-1 7	280	252	32 6	169	125	5.06
315	25173031517	315 SDR 33-1 7	315	261	36 6	185.5	130	6.42
355	2517303551 7	355 SDR 33-1 7	355	282	413	205. 5	140	8.94
400	2517304001 7	400 SDR 33-1 7	400	30 3	46 6	235. 5	150	11.8
450	2517304501 7	450 SDR 33-1 7	450	34 0	522	260	168	16.6
500	2517305001 7	500 SDR 33-1 7	500	361	579	286	179	22

E-Coupler – 10 Bar / Gas 6 Bar – PE100 RC Black Agruline

AGRU Code: 173.9

MOP Water 10 bar / Gas 6 bar

Injection Moulded

Electrofusion

Available in **PE100 RC Black**

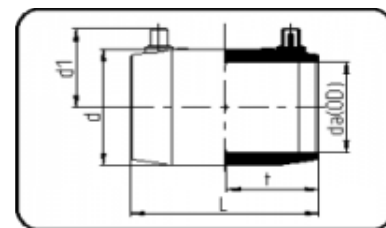

DIMENSION	CODE	DETAIL	da(O D) mm	L m m	d m m	d1 mm	t mm	WEIGHT
90	2517390901 7	90 SDR 33-17	90	141	109	74	69	0.369
110	25173911017	110 SDR 33-17	110	152	133	82	75	0.56
160	2517391601 7	160 SDR 33-1 7	160	181	188	107.5	89.5	1.1
200	2517392001 7	200 SDR 33-1 7	200	217	234	127	106.5	2.16
225	2517392251 7	225 SDR 33-1 7	225	232	263	142	113.5	2.8
250	2517392501 7	250 SDR 33-1 7	250	242	293	152.5	120	3.8
280	2517392801 7	280 SDR 33-1 7	280	252	326	169	125	5.06
355	2517393551 7	355 SDR 33-1 7	355	282	413	205.5	140	8.94
400	2517394001 7	400 SDR 33-1 7	400	303	466	235.5	150	12.3
500	2517395001 7	500 SDR 33-1 7	500	361	579	286	179	21.2

E-Coupler – 16 Bar / Gas 10 Bar

Agruline

AGRU Code: 173

MOP Water 16 bar / Gas 10 bar

Injection Moulded

Electrofusion

Available in PE100 Black

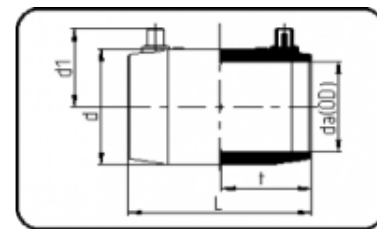

DIMENSION	CODE	DETAIL	da(OD) mm	L mm	d mm	d1 mm	t mm	WEIGHT
20	2517300201	20 SDR 11-7.4	20	75	30	37	37	0.035
25	2517300251	25 SDR 11-7.4	25	81	35	39	40	0.038
32	2517300321	32 SDR 11-7.4	32	89	42	43	44	0.048
40	2517300401	40 SDR 17-7.4	40	99	53	47	49	0.084
50	2517300501	50 SDR 17-7.4	50	110	66.5	53	55	0.143
63	2517300631	63 SDR 17-7.4	63	127	83	59	63	0.249
75	2517300751	75 SDR 17-7.4	75	141	97	65.5	70	0.35
90	2517300901	90 SDR 17-7.4	90	141	112	72	69	0.46
110	25173011011	110 SDR 17-7.4	110	152	136	83	75	0.73
125	25173012511	125 SDR 17-7.4	125	172	155	91	84.5	1.032
140	2517301401	140 SDR 17-7.4	140	181	173	99	89.5	1.37

160	2517301601 1	160 SDR 17-7. 4	160	181	197	109	89.5	1.71
180	2517301801 1	180 SDR 17-7. 4	180	201	221	119	99	2.46
200	2517302001 1	200 SDR 17-7. 4	200	217	245	127	106. 5	3.2
225	2517302251 1	225 SDR 17-7. 4	225	231	275	142	113.5	4.3
250	2517302501 1	250 SDR 17-7. 4	250	24 0	310	155	118	4.82
315	25173031511	315 SDR 17-7. 4	315	262	386	180. 5	129	8
355	2517303551 1	355 SDR 26-1 1	355	282	445	225	138	14.75
400	2517304001 1	400 SDR 26-1 1	400	30 2	499	254	148	19.8
450	2517304501 1	450 SDR 17-11	450	34 0	552	260	167.5	20.6
500	2517305001 1	500 SDR 17-11	500	36 0	604	289	180	26

E-Coupler – 16 Bar / Gas 10 Bar – PE100 RC Black

Agruline

AGRU Code: 173.9

MOP Water 16 bar / Gas 10 bar

Injection Moulded

Electrofusion

Available in **PE100 RC Black**

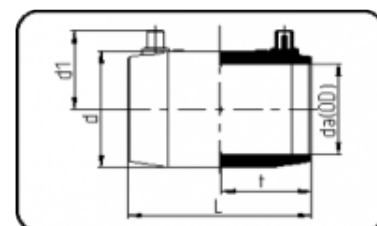

DIMENSION	CODE	DETAIL	da(OD) mm	L mm	d mm	d1 mm	t mm	WEIGHT
20	25173902011	20 SDR 11-7.4	20	75	30	37	37	0.035
50	25173905011	50 SDR 17-7.4	50	110	66.5	53	55	0.15
63	25173906311	63 SDR 17-7.4	63	127	83	59	63	0.26
75	25173907511	75 SDR 17-7.4	75	141	97	65.5	70	0.36
90	25173909011	90 SDR 17-7.4	90	141	112	72	69	0.46
110	25173911011	110 SDR 17-7.4	110	152	135	83	75	0.73
140	25173914011	140 SDR 17-7.4	140	181	180	99	89.5	1.59
160	25173916011	160 SDR 17-7.4	160	181	197	109	89.5	1.76
225	25173922511	225 SDR 17-7.4	225	231	275	142	113.5	4.34
250	25173925011	250 SDR 26-7.4	250	240	310	155	118	5.9
280	25173928011	280 SDR 26-7.4	280	251	346	180	123	7.7
315	25173931511	315 SDR 26-7.4	315	262	390	187	129	10.38
400	25173940011	400 SDR 26-11	400	302	499	254	148	19.8
500	25173950011	500 SDR 17-11	500	360	604	289	180	25.169

E-Coupler – Machined

Agruline

AGRU Code: 373

Machined

Electrofusion

Available in PE100 Black

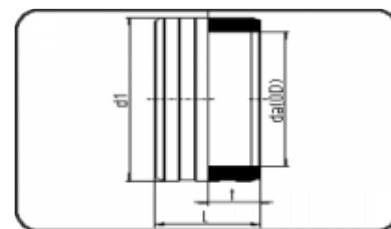

DIMENSION	CODE	DETAIL	WEIGHT
560	25373056017	560 SDR 33-17	27
630	25373063017	630 SDR 33-17	33.5
710	25373071017	710 SDR 33-17	40
800	25373080017	800 SDR 33-17	46.5
900	25373090017	900 SDR 33-17	53
1000	25373100017	1000 SDR 33-17	59.5
1200	25373120017	1200 SDR 33-17	66
1400	25373140017	1400 SDR33-17	72.5
560	25373056011	560 SDR 11	79
630	25373063011	630 SDR 11	85.5
710	25373071011	710 SDR 11	92
800	25373080011	800 SDR 11	98.5
900	25373090011	900 SDR 11	105

E-End Cap

Agruline

AGRU Code: 174

MOP Water 16 bar / Gas 10 bar

Injection Moulded

Electrofusion

Available in PE100 Black

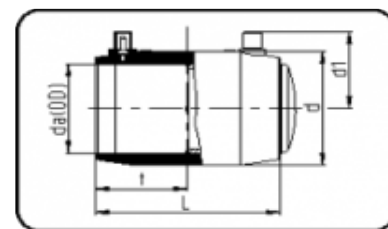

DIMENSI ON	CODE	DETAIL	da(O) D) mm	L m m	d m m	d1 mm	t mm	WEIG HT
20	25174002 011	20 SDR 11/9/7.4	20	75	30	37	37	0.038
25	25174002 511	25 SDR 11/9/7.4	25	81	35	39	40	0.053
32	25174003 211	32 SDR 11/9/7.4	32	89	42	43	44	0.068
40	25174004 011	40 SDR 17/13.6/11/9/7. 4	40	99	53	44	49	0.114
50	25174005 011	50 SDR 17/13.6/11/9/7. 4	50	110	66. 5	53	55	0.2
63	25174006 311	63 SDR 17/13.6/11/9/7. 4	63	127	83	59	63	0.35
75	25174007 511	75 SDR 17/13.6/11/9/7. 4	75	141	97	65. 5	70	0.5
90	25174009 011	90 SDR 17/13.6/11/9/7. 4	90	141	112	72	69	0.732
110	251740110 11	110 SDR 17/13.6/11/9/ 7.4	110	152	136	83	75	1.23

125	25174012 511	125 SDR 17/13.6/11/9/ 7.4	125	172	155	91	84.5	1.7
140	25174014 011	140 SDR 17/13.6/11/9/ 7.4	140	181	180	99	89.5	2.4
160	25174016 011	160 SDR 17/13.6/11/9/ 7.4	160	181	197	107. 5	89.5	2.92
180	25174018 011	180 SDR 26/17/13.6/1 1/9/7.4	180	20 1	221	119	99	4.18
200	25174020 011	200 SDR 26/17/13.6/1 1/9/7.4	200	217	245	127	106. 5	5.32
225	25174022 511	225 SDR 26/17/13.6/1 1/9/7.4	225	231	275	142	113. 5	7.2
250	25174025 011	250 SDR 26/17/13.6/1 1/9/7.4	250	24 0	310	155	118	8.84
280	25174028 011	280 SDR 26/17/13.6/1 1/9/7.4	280	251	34 6	180	123	12.66
315	25174031 511	315 SDR 26/17/13.6/1 1/9/7.4	315	26 2	38 6	187	129	14.7

E-Reducer Concentric

Agruline

AGRU Code: 177

MOP Water 16 bar / Gas 10 bar

Injection Moulded

Electrofusion

Available in PE100 Black

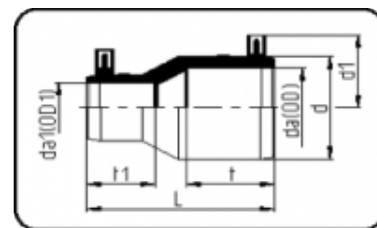

DIMENSION	CODE	DETAIL	da (OD) mm	da1 (OD 1) mm	L m m	d m m	d1 m m	t m m	t1 m m	WEI GHT
25/20	251772 52011	25/20 SDR 11/9/ 7.4	25	20	11 0	35	37	40	37	0.05 6
32/20	251773 22011	32/20 SDR 11/9/ 7.4	32	20	11 0	43	43	44	37	0.06 5
32/25	251773 22511	32/25 SDR 11/9/ 7.4	32	25	11 0	42	44	44	40	0.071
40/20	251774 02011	40/20 SDR 11/ 9/7.4	40	20	12 0	53	48	49	37	0.09 2
40/25	251774 02511	40/25 SDR 11/9/ 7.4	40	25	12 0	53	48	49	41	0.09 4
40/32	251774 03211	40/32 SDR 11/ 9/7.4	40	32	12 0	53	47	49	44	0.1
50/25	251775 02511	50/25 SDR 11/9/ 7.4	50	25	13 5	67	49	55	41	0.143
50/32	251775 03211	50/32 SDR 11/9/ 7.4	50	32	13 5	67	53	55	43. 5	0.15
50/40	251775 04011	50/40 SDR 17/1 3.6/11/9/7.4	50	40	13 5	67	53	55	48. 5	0.165
63/32	251776 33211	63/32 SDR 11/9/ 7.4	63	32	13 4	83	56	62. 7	43. 5	0.23
63/40	251776 34011	63/40 SDR 17/1 3.6/11/9/7.4	63	40	13 4	83	56	62. 7	48. 5	0.24
63/50	251776 35011	63/50 SDR 17/1 3.6/11/9/7.4	63	50	15 0	83	59. 5	62. 7	54. 2	0.27 3

75/50	251777 55011	75/50 SDR 17/1 3.6/11/9/7.4	75	50	15 7	97	63	70	55	0.33 6
75/63	251777 56311	75/63 SDR 17/1 3.6/11/9/7.4	75	63	15 7	97	63	70	63	0.38
90/63	251779 06311	90/63 SDR 17/1 3.6/11/9/7.4	90	63	17 3	117	73. 5	72	63. 5	0.55
110/63	251771 16311	110/63 SDR 17/1 3.6/11/9/7.4	110	63	20 2	14 0.5	84	72. 5	63. 5	0.86
110/90	251771 19011	110/90 SDR 17/1 3.6/11/9/7.4	110	90	18 2	14 0.5	84	72. 5	71. 5	0.94
125/90	251771 29011	125/90 SDR 17/1 3.6/11/9/7	125	90	18 5	156	90	83. 5	69. 2	0.99 2
125/110	251771 21111	125/110 SDR 17/ 13.6/11/9/7	125	110	17 5	156	90	83	70	1.05
160/90	251771 69011	160/90 SDR 17/1 3.6/11/9/7.4	160	90	24 2	20 0	10 8.5	90. 5	71	1.89
160/110	251771 61111	160/110 SDR 17/ 13.6/11/9/7.4	160	110	22 6	20 0	10 8.5	90. 5	71. 5	2
225/160	251772 21611	225/160 SDR 1 7/13.6/11/9/7.4	225	160	28 4	28 0	147	114	89	5.12

E-Screw Cap

Agruline

AGRU Code: 277

For Tapping Saddle

Injection Moulded

Electrofusion

Available in PE100 Black

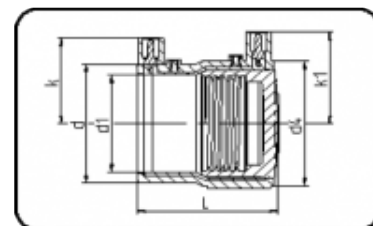

DIMENSION	CODE	DETAIL	L m m	d m m	d1 m m	d4 mm	k m m	k1 m m	WEIGHT
63	25277006 311	63 SDR11 ISO S-5	75. 5	70. 2	56	74. 5	52	56	0.15
90-315	25277903 111	90-315 SDR11 ISO S-5	83	78	64	82. 6	56	60	0.195

E-Tee

Agruline

AGRU Code: 176

MOP Water 16 bar / Gas 10 bar

Injection Moulded

Electrofusion

Available in PE100 Black

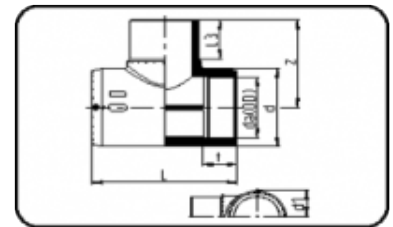

DIMENSION	CODE	DETAIL	da(O D) mm	z m m	L m m	L3 m m	d m m	d1 m m	t m m	WEIGHT
20	251760 02011	20 SDR 11/9/7.4	20	60	11 2	42. 5	32	36	37	0.06 5
25	251760 02511	25 SDR 11/9/7.4	25	66	11 2	42. 5	37	39. 5	40. 2	0.08
32	251760 03211	32 SDR 11/9/7.4	32	76	12 4	47	47	43. 5	44	0.125
40	251760 04011	40 SDR 17/13.6/ 11/9/7.4	40	86	14 1	50. 5	58. 5	47. 5	49	0.20 6
50	251760 05011	50 SDR 17/13.6/ 11/9/7.4	50	10 0.5	16 2	58	70	52. 5	55	0.3

63	251760 06311	63 SDR 17/13.6/ 11/9/7.4	63	116	18 7	64. 5	88	60	63	0.53 8
75	251760 07511	75 SDR 17/13.6/ 11/9/7.4	75	128	21 2	71. 5	97	64	70	0.65
90	251760 09011	90 SDR 17/13.6/ 11/9/7.4	90	171. 5	29 4	91	124	72. 5	76. 5	1.72
110	251760 11011	110 SDR 17/13. 6/11/9/7.4	110	190	32 8	101	14 8.5	85	72	2.67
125	251760 12511	125 SDR 17/13. 6/11/9/7.4	125	215	34 9	111	170	93. 1	86. 5	3.7
160	251760 16011	160 SDR 17/13. 6/11/9/7.4	160	24 5	37 2	12 2	211. 5	110. 5	86	6.12
180	251760 18011	180 SDR 26/17/1 3.6/11/9/7.4	180	275	42 1	13 0	232	12 3.5	99. 5	9
225	251760 22511	225 SDR 26/17/ 13.6/11/9/7.4	225	325	48 2	14 7	287	150	111	13.4

Spigot Saddle

Agruline

AGRU Code: 288

Bottom section screwable

Injection Moulded

Electrofusion

Available in PE100 Black

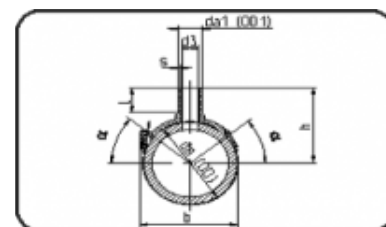

DIMENSION	CODE	DETAIL	da (OD) mm	da1 (OD 1) mm	h mm	d3 mm	b mm	s mm	alp h [°]	L mm	WEI GHT

160/3 2	70288 163211	160/32 SDR 11 ISO S-5	160	32	16 8	24	19 3.5	3	0	60	0.44 4
160/4 0	70288 164011	160/40 SDR 11 ISO S-5	160	40	16 8	31	19 3.5	3.7	0	64	0.42 8
160/5 0	70288 165011	160/50 SD R11 ISO S-5	160	50	18 4	36	19 3.5	4. 6	0	71	0.48 7
160/6 3	70288 166311	160/63 SDR 11 ISO S-5	160	63	18 4	45	19 3.5	5. 8	0	77	0.51
160/9 0	70288 169011	160/90 SD R11 ISO S-5	160	90	20 2	65	19 6.5	8. 2	0	92	0.88 1
160/11 0	70288 161111	160/110 SD R11 ISO S-5	160	110	20 2	84	19 6.5	10	0	98	0.94 9
180/3 2	70288 183211	180/32 SD R11 ISO S-5	180	32	17 7	24	21 4.5	3	0	60	0.47 2
180/4 0	70288 184011	180/40 SD R11 ISO S-5	180	40	17 7	31	21 4.5	3.7	0	64	0.48 1
180/5 0	70288 185011	180/50 SD R11 ISO S-5	180	50	19 3	36	21 4.5	4. 6	0	71	0.56 5
180/6 3	70288 186311	180/63 SDR 11 ISO S-5	180	63	19 3	45	21 4.5	5. 8	0	77	0.58 9
180/9 0	70288 189011	180/90 SD R11 ISO S-5	180	90	21 6	65	21 6.5	8. 2	0	92	1.00 5
180/11 0	70288 181111	180/110 SD R11 ISO S-5	180	110	21 6	84	21 6.5	10	0	98	1.09 5
225/3 2	70288 223211	225/32 SD R11 ISO S-5	225	32	20 3	24	22 3	3	0	60	0.46 4
225/4 0	70288 224011	225/40 SD R11 ISO S-5	225	40	20 3	31	22 3	3.7	0	64	0.47

225/50	70288 225011	225/50 SD R11 ISO S-5	225	50	21 9	36	22 3	4. 6	40	71	0.53
225/63	70288 226311	225/63 SD R11 ISO S-5	225	63	21 9	45	22 3	5. 8	40	77	0.55 5
225/90	70288 229011	225/90 SD R11 ISO S-5	225	90	23 7	65	24 4.5	8. 2	30	92	0.94 2
225/110	70288 221111	225/110 SD R11 ISO S-5	225	110	23 7	84	24 4.5	10	30	97	1.01 8
250/63	70288 256311	250/63 SD R11 ISO S-5	250	63	23 1	45	24 2	5. 8	40	77	0.55
250/90	70288 259011	250/90 SD R11 ISO S-5	250	90	25 1	65	26 6	8. 2	30	92	0.99 1
250/110	70288 251111	250/110 SD R11 ISO S-5	250	110	25 1	84	26 6	10	30	98	1.06 8
315/63	70288 316311	315/63 SDR 11 ISO S-5	315	63	26 6	45	29 4	5. 8	40	77	0.61 9
315/90	70288 319011	315/90 SDR 11 ISO S-5	315	90	28 5	65	32 6.5	8. 2	30	92	1.05 9
315/110	70288 311111	315/110 SD R11 ISO S-5	315	110	28 5	84	32 6.5	10	30	98	1.185

Steel – R – Female Thread – For E-Adaptor

Agruline

AGRU Code: 180.1

Injection Moulded

Electrofusion

Available in PE100 Black

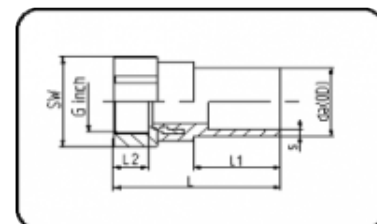

DIMENSION	CODE	DETAIL	da (OD) mm	s mm	L mm	L1 mm	L2 mm	S W mm	G mm	K mm	E mm	WEIGHT
20 X 1/2	25180 10201 1	20X1/2" SDR 11	20	3	76	40	27	32	0.5	18.63	20.96	0.118
25 X 3/4	25180 10251 1	25X3/4" SDR 11	25	3	80	43	34	36	0.75	24.12	26.44	0.141
32 X 1	25180 10321 1	32X1" SDR 11	32	3	88	46	34	41	1	30.29	33.25	0.181
40 X 1 1/4	25180 10401 1	40X1 1/4" SDR 11	40	3.7	98	51	36	50	1.25	38.95	41.91	0.275
50 X 1 1/2	25180 10501 1	50X1 1/2" SDR 11	50	4.6	110	57	43	60	1.5	44.85	47.8	0.492
63 X 2	25180 10631 1	63X2" SDR 11	63	5.8	129	65	52	70	2	56.66	59.61	0.718

Steel – R – Male Thread – For E-Adaptor

Agruline

AGRU Code: 181.1

Injection Moulded

Electrofusion

Available in PE100 Black

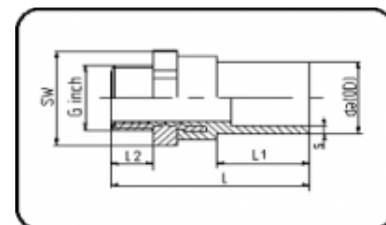

DIMENSION	CODE	DETAIL	da (OD) mm	s mm	L mm	L1 mm	L2 mm	S mm	G mm	K mm	E mm	WEIGHT
20 X 1/2	25181 10201 1	20X1/2" SDR 11	20	3	81	40	16	32	0.5	18.63	20.96	0.097
25 X 3/4	25181 10251 1	25X3/4" SDR 11	25	3	85	43	16	36	0.75	24.12	26.44	0.126
32 X 1	25181 10321 1	32X1" SDR 11	32	3	92	46	19	41	1	30.29	33.25	0.175
40 X 1 1/4	25181 10401 1	40X1 1/4" SDR 11	40	3.7	100	51	21	50	1.25	38.95	41.91	0.256
50 X 1 1/2	25181 10501 1	50X1 1/2" SDR 11	50	4.6	109	57	23	60	1.5	44.85	47.8	0.347
63 X 2	25181 10631 1	63X2" SDR 11	63	5.8	124	65	27	70	2	56.66	59.61	0.538

Tapping Saddle with Brass Valve Integrated Cutter

Agruline

AGRU Code: 079

Electrofusion

Available in PE100 Black

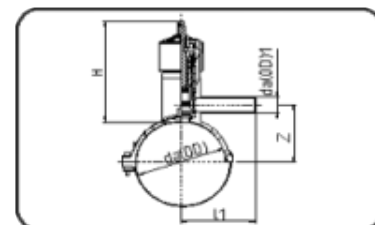

DIMENSI ON	CODE	DETAIL	da(O D) mm	L1 mm	h m m	z mm	da1 (OD 1) mm	WEIGH T
63/32	70079633 211	63/32 SDR11 ISO S -5	63	131	163	65.3	32	1.542
63/40	70079634 011	63/40 SDR11 ISO S -5	63	140	163	65.3	40	1.66
63/50	70079635 011	63/50 SDR11 ISO S -5	63	160. 5	163	65.3	50	1.7
63/63	70079636 311	63/63 SDR11 ISO S -5	63	187	163	65.3	63	1.77
90/32	70079903 211	90/32 SDR11 ISO S -5	90	135	20 3	79	32	2.42
90/40	70079904 011	90/40 SDR11 ISO S -5	90	145	20 3	79	40	2.44
90/50	70079905 011	90/50 SDR11 ISO S -5	90	161	20 3	79	50	2.5
90/63	70079906 311	90/63 SDR11 ISO S -5	90	192	20 3	79	63	2.519
110/32	700791132 11	110/32 SDR11 ISO S-5	110	137	20 3	87	32	2.46
110/40	700791140 11	110/40 SDR11 ISO S-5	110	147	20 3	87	40	2.498
110/50	700791150 11	110/50 SDR11 ISO S-5	110	160	20 3	87	50	2.497
110/63	700791163 11	110/63 SDR11 ISO S-5	110	192. 6	20 3	87	63	2.588

125/32	700791232 11	125/32 SDR11 ISO S-5	125	137	20 3	95.9	32	2.49
125/40	700791240 11	125/40 SDR11 ISO S-5	125	147	20 3	95.9	40	2.491
125/50	700791250 11	125/50 SDR11 ISO S-5	125	161	20 3	95.9	50	2.52
125/63	700791263 11	125/63 SDR11 ISO S-5	125	192	20 3	95.9	63	2.61
160/32	700791632 11	160/32 SDR11 ISO S-5	160	137	20 3	113. 2	32	2.55
160/40	700791640 11	160/40 SDR11 ISO S-5	160	147	20 3	113. 2	40	2.56
160/50	700791650 11	160/50 SDR11 ISO S-5	160	161	20 3	113. 2	50	2.6
160/63	700791663 11	160/63 SDR11 ISO S-5	160	189	20 3	113. 2	63	2.68
180/32	700791832 11	180/32 SDR11 ISO S-5	180	137	20 3	124	32	2.644
180/40	700791840 11	180/40 SDR11 ISO S-5	180	147	20 3	124	40	2.623
180/50	700791850 11	180/50 SDR11 ISO S-5	180	161	20 3	124	50	2.689
180/63	700791863 11	180/63 SDR11 ISO S-5	180	189	20 3	124	63	2.772
200/32	70079203 211	200/32 SDR11 ISO S-5	200	135	20 3	134	32	2.48
200/40	70079204 011	200/40 SDR11 ISO S-5	200	145	20 3	134	40	2.48

200/50	70079205011	200/50 SDR11 ISO S-5	200	160	203	134	50	2.52
200/63	70079206311	200/63 SDR11 ISO S-5	200	190	203	134	63	2.6
225/32	70079223211	225/32 SDR11 ISO S-5	225	137	203	147.6	32	2.55
225/40	70079224011	225/40 SDR11 ISO S-5	225	147	203	147.6	40	2.553
225/50	70079225011	225/50 SDR11 ISO S-5	225	160	203	147.6	50	2.6
225/63	70079226311	225/63 SDR11 ISO S-5	225	192	203	147.6	63	2.7
250/63	70079256311	250/63 SDR11 ISO S-5	250	224.5	203	0	63	2.495
315/63	70079316311	315/63 SDR11 ISO S-5	315	192	203	0	63	2.8

Tapping Saddle with Screw Cap

Agruline

AGRU Code: 278

Gas-tight bottom section screwable

Injection Moulded

Electrofusion

Available in PE100 Black

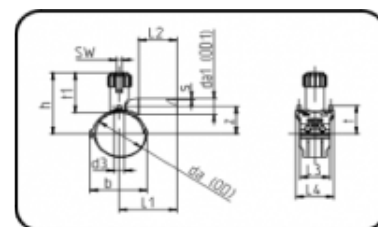

scroll to see whole table

DI ME NS IO N da (O D) m m / da 1 (O D 1) m m	C O D E	DET AIL	s m m	z m m	L 1 m m	L 2 m m	L 3 m m	L 4 m m	d 3 m m	h m m	b m m	S W m m	t m m	t1 m m	W E I G H T
6 3/ 20	25 27 86 32 01 1	63/ 20 SDR 11 IS O S- 5	3	6 0	1 2 0	7 8	1 0 2	11 9	2 6	16 9. 5	9 9	1 0	5 9. 5	1 3 8	0. 5 6
6 3/ 32	25 27 86 33 21 1	63/ 32 SDR 11 IS O S- 5	3	5 7	1 2 9	9 2	1 0 2	11 9	2 6	16 9. 5	9 9	1 0	5 9. 5	1 3 8	0. 5 8
6 3/ 40	25 27 86 34 01 1	63/ 40 SDR 11 IS O S- 5	3. 7	5 8. 5	1 4 1	1 0 2	1 0 2	11 9	2 6	16 9. 5	9 9	1 0	5 9. 5	1 3 8	0. 5 8

63/63	2527863631	63/63 SDR 11 IS OS-5	5.8	60	178	130	102	119	26	169.5	99	10	59.5	138	0.69
90/32	2527890321	90/32 SDR 11 IS OS-5	3	67	130	92	103	130	32	196.5	128	17	73	152	0.785
90/63	2527890631	90/63 SDR 11 IS OS-5	5.8	67	184	130	103	130	32	196.5	128	17	73	152	0.885
110/20	2527811201	110/20 SDR 11 IS OS-5	3	76	120	78	103	130	32	206.5	149	17	83	152	0.812
110/32	2527811321	110/32 SDR 11 IS OS-5	3	76	131	95	103	130	32	206.5	149	17	83	152	0.8
110/40	2527811401	110/40 SDR 11 IS OS-5	3.7	76	151	102	103	130	32	206.5	149	17	83	152	0.834

11 0/ 63	25 27 81 16 31 1	110/ 63 SDR 11 IS 0 S- 5	5. 8	8 2. 5	1 8 5	1 3 0	1 0 3	1 3 0	3 2	2 0 6. 5	14 9	17	8 3	1 5 2	0. 9 4 5
12 5/ 20	25 27 81 22 01 1	12 5/2 0 S DR1 1 IS 0 S- 5	3	8 2	1 2 0	7 8	1 0 3	1 3 0	3 2	21 4	16 6	17	91	1 5 2	0. 81
12 5/ 32	25 27 81 23 21 1	12 5/3 2 S DR1 1 IS 0 S- 5	3	8 2	1 3 1	9 5	1 0 3	1 3 0	3 2	21 4	16 6	17	91	1 5 2	0. 8 2
12 5/ 40	25 27 81 24 01 1	12 5/4 0 S DR1 1 IS 0 S- 5	3. 7	8 2	1 51	1 0 2	1 0 3	1 3 0	3 2	21 4	16 4	17	91	1 5 2	0. 8 5
12 5/ 63	25 27 81 26 31 1	12 5/6 3 S DR1 1 IS 0 S- 5	5. 8	8 2	1 8 5	1 3 0	1 0 3	1 3 0	3 2	21 4	16 2	17	91	1 5 2	0. 9 8

16 0/ 20	25 27 81 62 01 1	16 0/2 0 S DR1 1 IS 0 S- 5	3	9 8. 5	1 2 1	7 8	1 0 3	1 3 1	3 2	2 3 1. 5	2 0 4	17	10 8	1 5 2	0. 8 5
16 0/ 32	25 27 81 63 21 1	16 0/3 2 S DR1 1 IS 0 S- 5	3	9 9	1 3 0	9 2	1 0 3	1 3 1	3 2	2 3 1. 5	2 0 4	17	10 8	1 5 2	0. 8 9
16 0/ 40	25 27 81 64 01 1	16 0/4 0 S DR1 1 IS 0 S- 5	3. 7	10 3. 5	1 4 8	1 0 2	1 0 3	1 3 1	3 2	2 3 1. 5	2 0 0	17	10 8	1 5 2	0. 93
16 0/ 63	25 27 81 66 31 1	16 0/6 3 S DR1 1 IS 0 S- 5	5. 8	10 2. 5	1 9 8	1 3 0	1 0 3	1 3 1	3 2	2 3 1. 5	2 0 0	17	10 8	1 5 2	1. 0 5 8
18 0/ 32	25 27 81 83 21 1	18 0/3 2 S DR1 1 IS 0 S- 5	3	11 5	1 3 0	9 5	1 0 2	1 4 2	3 2	2 4 1. 5	2 2 0	17	12 1	1 5 2	0. 93 3

18 0/ 63	25 27 81 86 31 1	18 0/6 3 S DR1 1 IS 0 S- 5	5. 8	11 5	1 9 8	1 3 0	1 0 3	1 4 2	3 2	2 4 1. 5	2 2 0	17	12 1	1 5 2	1. 07
20 0/ 20	25 27 82 02 01 1	20 0/2 0 S DR1 1 IS 0 S- 5	3	11 6	1 2 0	7 8	1 0 2	1 4 2	3 2	2 5 1. 5	2 5 3	17	12 8	1 5 2	0. 99
20 0/ 32	25 27 82 03 21 1	20 0/3 2 S DR1 1 IS 0 S- 5	3	11 8	1 3 0	9 5	1 0 2	1 4 2	3 2	2 5 1. 5	2 5 3	17	12 8	1 5 2	1
20 0/ 40	25 27 82 04 01 1	20 0/4 0 S DR1 1 IS 0 S- 5	3. 7	11 8	1 5 8	1 0 2	1 0 2	1 4 2	3 2	2 5 1. 5	2 5 3	17	12 8	1 5 2	1. 0 4
20 0/ 63	25 27 82 06 31 1	20 0/6 3 S DR1 1 IS 0 S- 5	5. 8	12 2	1 9 8	1 3 0	1 0 2	1 4 2	3 2	2 5 1. 5	2 5 0	17	12 8	1 5 2	1.1 2

22 5/ 32	25 27 82 23 21 1	22 5/3 2 S DR1 1 IS 0 S- 5	3	13 4. 5	1 3 0	9 2	1 0 2	1 4 2	3 2	2 9 7	2 7 5	17	14 0. 5	1 8 4	1.1 7
22 5/ 63	25 27 82 26 31 1	22 5/6 3 S DR1 1 IS 0 S- 5	5. 8	14 3. 5	2 0 7	1 3 0	1 0 2	1 4 2	3 2	2 9 7	2 6 5. 5	17	14 0. 5	1 8 4	1. 2

Renowned Supplier of High Quality Plastic Products

Call Us
(tel:1300136698)

Email Us
(mailto:sales@agru.com.au)



Agru Australia Pty Ltd

