

# 90° Bend

## Agruline

**AGRU Code: 001**

Injection Moulded

Butt Weld

Available in PE100 Black

SDR: 33, 17 & 11

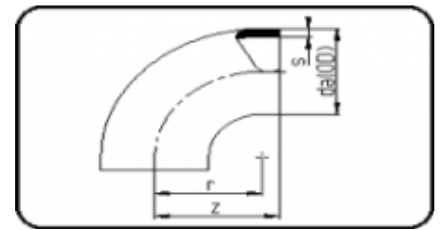

DIMENSION	CODE	DETAIL	da(O D) mm	s mm	z mm	r mm	WEIGHT
<b>SDR 33</b>							
110	25001011033	110X3.4 SDR33 ISO S-16	110	3.4	120	110	0.246
125	25001012533	125X3.9 SDR33 ISO S-16	125	3.9	140	125	0.352
140	25001014033	140X4.3 SDR33 ISO S-16	140	4.3	150	140	0.474
160	25001016033	160X4.9 SDR33 ISO S-16	160	4.9	180	155	0.953
180	25001018033	180X5.5 SDR33 ISO S-16	180	5.5	200	180	1.22
200	25001020033	200X6.2 SDR33 ISO S-16	200	6.2	220	200	1.74
225	25001022533	225X6.9 SDR33 ISO S-16	225	6.9	245	225	2.28
250	25001025033	250X7.7 SDR33 ISO S-16	250	7.7	290	265	3.44

280	2500102803	280X8.6 SDR33 ISO S-16	280	8.6	290	260	4.34
315	2500103153	315X9.7 SDR33 ISO S-16	315	9.7	340	300	6.34
355	2500103553	355X10.9 SDR33 ISO S-16	355	10.9	340	300	8.9
400	2500104003	400X12.3 SDR33 ISO S-16	400	12.3	345	300	11.12
450	2500104503	450X13.8 SDR33 ISO S-16	450	13.8	445	400	15
500	2500105003	500X15.3 SDR33 ISO S-16	500	15.3	445	400	18.48
<b>SDR 17</b>							
250	25001025017	250X14.8 SDR17 ISO S-8	250	14.8	285	265	5.86
280	25001028017	280X16.6 SDR17 ISO S-8	280	16.6	290	265	7.14
315	25001031517	315X18.7 SDR17 ISO S-8	315	18.7	335	300	10.74
355	25001035517	355X21.1 SDR17 ISO S-8	355	21.1	340	300	12.22
400	25001040017	400X23.7 SDR17 ISO S-8	400	23.7	340	300	15.6
450	25001045017	450X26.7 SDR17 ISO S-8	450	26.7	445	400	25.94
500	25001050017	500X29.7 SDR17 ISO S-8	500	29.7	445	400	31.94

<b>SDR 11</b>							
250	25001025011	250X22.7 SDR11 ISO S-5	250	22.7	29 0	265	8.02
280	25001028011	280X25.4 SDR11 ISO S-5	280	25. 4	29 0	265	9.75
315	25001031511	315X28.6 SDR11 ISO S-5	315	28. 6	34 0	30 0	14.36
355	25001035511	355X32.2 SDR11 ISO S-5	355	32. 2	34 0	30 0	18.46
400	25001040011	400X36.3 SDR11 ISO S-5	400	36. 3	34 5	30 0	23.5
450	25001045011	450X40.9 SDR11 ISO S-5	450	40. 9	44 5	40 0	38.8
500	25001050011	500X45.4 SDR11 ISO S-5	500	45. 4	44 5	40 0	48.34

# Adaptor Female Thread

## Agruline

### AGRU Code: 032

R-Thread FPR Reinforced

Injection Moulded

Butt Weld

Available in PE100 Black

SDR: 11

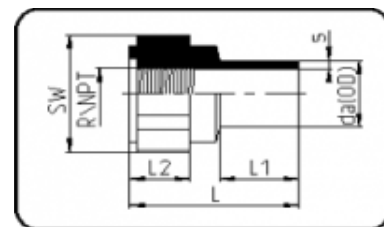

<b>DIM ENSI ON</b>	<b>COD E</b>	<b>DETAIL</b>	<b>da (O D) m m</b>	<b>s m m</b>	<b>L m m</b>	<b>L1 m m</b>	<b>L2 m m</b>	<b>S W m m</b>	<b>R in ch</b>	<b>K m m</b>	<b>E m m</b>	<b>WEI GH T</b>

SDR 11												
20	2503 2202 011	20X1/2" S DR11 ISO S-5	20	2	45	21	16	32	0. 5	18. 63	20. 96	0.0 14
25	2503 2252 511	25X3/4" SDR11 IS O S-5	25	2. 3	51	24	18	41	0. 75	24. 12	26. 44	0.0 26
32	2503 2323 211	32X1" SD R11 ISO S -5	32	3	58	3 0	20	46	1	30. 29	33. 25	0.0 34
40	2503 2404 011	40X1 1/4" SDR11 IS O S-5	40	3. 7	62	3 0	24	55	1.2 5	38. 95	41. 91	0.0 52
50	2503 2505 011	50X1 1/2" SDR11 IS O S-5	50	4. 6	6 8	34	2 5. 5	70	1.5	44. 85	47. 8	0.0 98
63	2503 2636 311	63X2" SD R11 ISO S -5	63	5. 8	75	36	30	85	2	56. 66	59. 61	0.16 5

# Adaptor Male Thread

## Agruline

**AGRU Code: 033**

R-Thread

Injection Moulded

Butt Weld

Available in PE100 Black

SDR: 11



DIMENSION	CODE	DETAIL	da (OD) mm	s mm	L mm	L1 mm	L2 mm	S W mm	R inch	K mm	E mm	WEIGHT
<b>SDR 11</b>												
20	2503 3202 011	20X1/2" SDR11 IS O S-5	20	2	46	2 0. 5	18	22	0. 5	18. 63	20. 96	0.0 07
25	2503 3252 511	25X3/4" SDR11 IS O S-5	25	2. 3	51	2 2. 5	20	27	0. 75	24. 12	26. 44	0.0 1
32	2503 3323 211	32X1" SD R11 ISO S -5	32	3	61	28	24	36	1	30. 29	33. 25	0.0 22
40	2503 3404 011	40X1 1/4" SDR11 IS O S-5	40	3. 7	66	29	2 6. 5	46	1.2 5	38. 95	41. 91	0.0 37
50	2503 3505 011	50X1 1/2" SDR11 IS O S-5	50	4. 6	74	32	28	55	1.5	44. 85	47. 8	0.0 59
63	2503 3636 311	63X2" SD R11 ISO S -5	63	5. 8	8 0	35	31	65	2	56. 66	59. 61	0.0 93

## End Cap

### Agruline

**AGRU Code: 004**

Injection Moulded

Butt Weld

Available in PE100 Black

SDR: 11

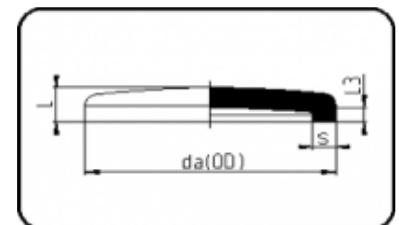

DIMENSION	CODE	DETAIL	da(OD) mm	s mm	z mm	r mm	WEIGHT
<b>SDR 11</b>							
355	2500403551 1	355 X 32.2 SDR11 ISO S-5	355	32.2	124	63	6.4
400	2500404001 1	400 X 36.3 SDR11 ISO S-5	400	36.3	133	72	8.72
450	2500404501 1	450 X 40.9 SDR11 ISO S-5	450	40.9	140	64	11.55
500	2500405001 1	500 X 45.4 SDR11 ISO S-5	500	45.4	148	65	14.8

## Reducer Concentric

### Agruline

**AGRU Code: 007**

Injection Moulded

Butt Weld

Available in PE100 Black

SDR: 33, 17 & 11

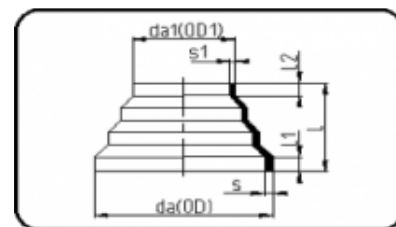

DIMENSION	CODE	DETAIL	da(OD) mm	da1(OD1) MM	s mm	L mm	L1 mm	L2 mm	s1 mm	WEIGHT
<b>SDR 33</b>										
110/63	2500711 6333	110/63 SDR33 ISO S-16	110	63	3.4	62	9	6	2	0.052

125/75	2500712 7533	125/75 SDR33 ISO S-16	125	75	3.9	72	13	8	2.3	0.104
160/110	2500716 1133	160/110 SDR33 ISO S-16	160	110	4.9	83	13	13	3.4	0.174
225/160	250072 21633	225/160 SDR33 ISO S-16	225	160	6.9	90	15	12	4.9	0.41
315/225	2500731 2233	315/225 SDR33 ISO S-16	315	225	9.7	130	25	20	6.9	1.16
450/315	250074 53133	450/315 SDR33 ISO S-16	450	315	13.8	170	27	20	9.7	3.46
630/450	250076 34533	630/450 SDR33 ISO S-16	630	450	19.3	188	30	20	13.8	9.8
<b>SDR 17</b>										
75/32	250077 53217	75/32 SDR17 ISO S-8	75	32	4.5	71	10	9	1.9	0.041
110/63	2500711 6317	110/63 SDR17 ISO S-8	110	63	6.6	62	9	6	3.8	0.096
125/75	2500712 7517	125/75 SDR17 ISO S-8	125	75	7.4	72	13	8	4.5	0.164
160/110	2500716 1117	160/110 SDR17 ISO S-8	160	110	9.5	83	13	13	6.6	0.291
225/160	250072 21617	225/160 SDR17 ISO S-8	225	160	13.4	90	15	12	9.5	0.683
315/225	2500731 2217	315/225 SDR17 ISO S-8	315	225	18.7	130	25	20	13.4	1.92
450/315	250074 53117	450/315 SDR17 ISO S-8	450	315	26.7	167	27	20	18.7	5.02

630/450	25007634517	630/450 SDR17 ISO S-8	630	450	37.4	188	30	20	26.7	11.5
<b>SDR 11</b>										
63/16	25007631611	63/16 SDR11 ISO S-5	63	16	5.8	97	10	8	1.8	0.043
75/32	25007753211	75/32 SDR11 ISO S-5	75	32	6.8	71	10	9	2.9	0.059
110/63	25007116311	110/63 SDR11 ISO S-5	110	63	10	62	9	6	5.8	0.139
125/75	25007127511	125/75 SDR11 ISO S-5	125	75	11.4	72	13	8	6.8	0.225
160/110	25007161111	160/110 SDR11 ISO S-5	160	110	14.6	83	13	13	10	0.429
225/160	25007221611	225/160 SDR11 ISO S-5	225	160	20.5	90	15	12	14.6	1.02
315/225	25007312211	315/225 SDR11 ISO S-5	315	225	28.6	130	25	20	20.5	2.68
450/315	25007453111	450/315 SDR11 ISO S-5	450	315	40.9	181	40	20	28.6	7.82

# Reducer Concentric

## Agruline

**AGRU Code: 009**

Injection Moulded

Butt Weld

Available in PE100 Black

SDR: 17

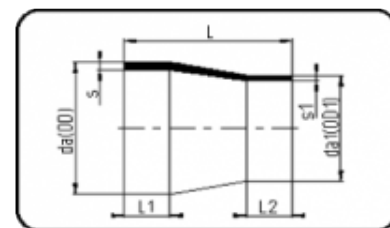



DIMENSION	CODE	DETAIL	da(OD) mm	da1(OD1) MM	s mm	L mm	L1 mm	L2 mm	s1 mm	WEIGHT
<b>SDR 17</b>										
75/63	2500975 6317	75/63 SDR17 ISO S-8	75	63	4.5	60	19	18	3.8	0.056
90/63	250099 06317	90/63 SDR17 ISO S-8	90	63	5.4	70	22	18	3.8	0.087
90/75	250099 07517	90/75 SDR17 ISO S-8	90	75	5.4	65	22	19	4.5	0.083

## Reducer Excentric

### Agruline

**AGRU Code: 005**

Injection Moulded

Butt Weld

Available in PE100 Black

SDR: 17 & 11

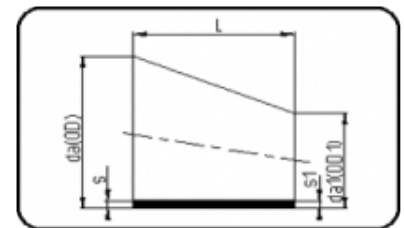

DIMENSION	CODE	DETAIL	da(OD) mm	s mm	z mm	-Tol	+Tol	r mm	WEIGHT
<b>SDR 17</b>									
250/160	25005251 633	250/160 SDR33 ISO S-16	250	16 0	7.7	15 5	6	6	4.9
355/250	25005352 533	355/250 SDR33 ISO S-16	355	25 0	11.1	20 0	6	6	7.8

250/160	25005251 617	250/160 SDR17 IS O S-8	250	16 0	14. 8	15 5	6	6	9.5
355/250	25005352 517	355/250 SDR17 IS O S-8	355	25 0	21.1	20 0	6	6	14.8
<b>SDR 11</b>									
250/160	25005251 611	250/160 SDR11 IS O S-5	250	16 0	22. 7	15 5	6	6	14.6
355/250	25005352 511	355/250 SDR11 IS O S-5	355	25 0	32. 2	20 0	6	6	22.7

## Spare Part Union 24

### Agruline

**AGRU Code: 380**

O-Ring Sealing

FPM

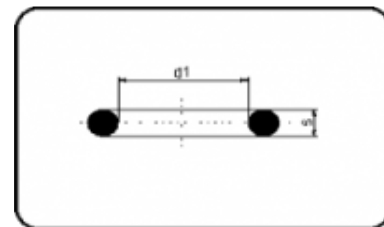

DIMENSION	CODE	DETAIL	da(OD) mm	s mm	d1 mm	WEIGHT
20	88380002000	20 - 22.22X3.53	20	3.53	20.22	0.005
25	88380002500	25 - 25.22X3.53	25	3.53	28.17	0.005
32	88380003200	32 - 32.92X3.53	32	3.53	32.92	0.002
40	88380004000	40 - 40.64X5.33	40	5.33	40.64	0.01
50	88380005000	50 - 47.00X5.33	50	5.33	47	0.007
63	88380006300	63 - 59.70X5.33	63	5.33	59.7	0.009

# Stub Flange – AS2129 & AS4087

## Agruline

**AGRU Code: 012**

Injection Moulded

Butt Weld

Available in PE100 Black

SDR: 33, 17 & 11

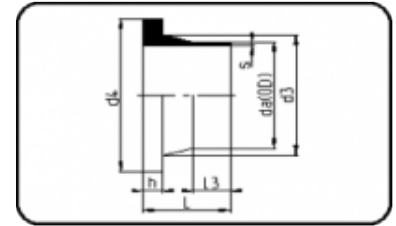

DIMENSION	CODE	DETAIL	da(0) D) mm	s m m	L m m	L3 m m	d3 m m	d4 m m	h m m	WEIGHT
<b>SDR 33</b>										
110	2501201 1033	110X3.4 SDR33 ISO S-16	110	3.4	80	31	12 5	15 8	18	0.3
125	2501201 2533	125X3.9 SDR33 ISO S-16	125	3.9	80	38	13 2	15 8	18	0.29 4
140	2501201 4033	140X4.3 SDR33 ISO S-16	140	4.3	80	32	15 5	18 8	18	0.43 6
160	2501201 6033	160X4.9 SDR33 ISO S-16	160	4.9	80	28. 5	17 5	21 2	18	0.571
180	2501201 8033	180X5.5 SDR33 ISO S-16	180	5.5	92	53	18 3	21 2	18	0.48
200	2501202 0033	200X6.2 SDR3 3 ISO S-16	200	6.2	113	53	23 2	26 8	18	1.1
225	2501202 2533	225X6.9 SDR33 ISO S-16	225	6.9	113	65	23 5	26 8	18	0.86 2
250	2501202 5033	250X7.7 SDR33 ISO S-16	250	7.7	132	70	28 5	32 0	20	1.821

280	2501202 8033	280X8.6 SDR3 3 ISO S-16	280	8.6	128	62	29 1	32 0	20	1.5
315	2501203 1533	315X9.7 SDR33 ISO S-16	315	9.7	136	68	33 5	37 0	20	2.25
355	2501203 5533	355X10.9 SDR3 3 ISO S-16	355	10. 9	150	75	37 3	43 0	23	2.94
400	2501204 0033	400X12.3 SDR3 3 ISO S-16	400	12. 3	155	75	42 7	48 2	26	4.04
450	2501204 5033	450X13.8 SDR3 3 ISO S-16	450	13. 8	170	70	51 4	58 5	33	8.08
500	2501205 0033	500X15.3 SDR3 3 ISO S-16	500	15. 3	175	86	53 0	58 5	33	7.14
560	2501205 6033	560X17.2 SDR3 3 ISO S-16	560	17. 2	124	36	61 5	68 5	35	9.92
630	2501206 3033	630X19.3 SDR3 3 ISO S-16	630	19. 3	180	89	64 2	68 5	35	8.86
<b>SDR 17</b>										
63	2501240 6317	63X3.8 SDR17 I SO S-8	63	3.8	50	20	75	10 2	14	0.114
75	2501240 7517	75X4.5 SDR17 I SO S-8	75	4.5	50	18	89	12 2	16	0.175
90	2501240 9017	90X5.4 SDR17 I SO S-8	90	5.4	81	40	10 5	13 8	17	0.28 3
110	2501201 1017	110X6.6 SDR17 I SO S-8	110	6.6	80	34	12 5	15 8	18	0.38 8
125	2501201 2517	125X7.4 SDR17 I SO S-8	125	7.4	84	46	13 2	15 8	18	0.36

140	2501201 4017	140X8.3 SDR17 ISO S-8	140	8.3	92	39	15 5	18 8	18	0.58 9
160	2501201 6017	160X9.5 SDR17 ISO S-8	160	9.5	92	42	17 5	21 2	18	0.741
180	2501201 8017	180X10.7 SDR17 ISO S-8	180	10. 7	92	53	18 3	21 2	20	0.73
200	2501202 0017	200X11.9 SDR1 7 ISO S-8	200	11. 9	110	46	23 2	26 8	24	1.56
225	2501202 2517	225X13.4 SDR1 7 ISO S-8	225	13. 4	112. 5	60	23 5	26 8	24	1.499
250	2501242 5017	250X14.8 SDR1 7 ISO S-8	250	14. 8	132	64	28 5	32 0	25	2.62
280	2501242 8017	280X16.6 SDR1 7 ISO S-8	280	16. 6	128	70	29 1	32 0	25	2.38
315	2501243 1517	315X18.7 SDR17 ISO S-8	315	18. 7	136	73	33 5	37 0	25	3.54
355	2501203 5517	355X21.1 SDR17 ISO S-8	355	21. 1	150	78	37 3	43 0	30	4.88
400	2501204 0017	400X23.7 SDR1 7 ISO S-8	400	23. 7	155	75	42 7	48 2	33	6.6
450	2501244 5017	450X26.7 SDR1 7 ISO S-8	450	26. 7	168	74	51 4	58 5	46	11.96
500	2501205 0017	500X29.7 SDR1 7 ISO S-8	500	29. 7	170	79	53 0	58 5	46	11.22
560	2501245 6017	560X33.2 SDR1 7 ISO S-8	560	33. 2	175	86	61 5	68 5	50	16.36
630	2501206 3017	630X37.4 SDR1 7 ISO S-8	630	37. 4	180	96	64 2	68 5	50	15.74

710	2501207 1017	710X42.1 SDR17 ISO S-8	710	42. 1	170	70	73 7	80 0	50	19.9
<b>SDR 11</b>										
20	250120 02011	20X2.0 SDR11 I SO S-5	20	2	52	30	27	45	7	0.016
25	250120 02511	25X2.3 SDR11 I SO S-5	25	2.3	50	25	33	58	9	0.02 9
32	250120 03211	32X3.0 SDR11 I SO S-5	32	3	50	25	40	68	10	0.04 3
40	250120 04011	40X3.7 SDR11 I SO S-5	40	3.7	50	24	50	78	11	0.06 4
50	250120 05011	50X4.6 SDR11 I SO S-5	50	4.6	53	22. 5	61	88	12	0.091
63	2501240 6311	63X5.8 SDR11 I SO S-5	63	5.8	50	20	75	10 2	14	0.129
75	2501240 7511	75X6.8 SDR11 I SO S-5	75	6.8	50. 5	18	89	12 2	16	0.20 4
90	2501240 9011	90X8.2 SDR11 I SO S-5	90	8.2	80	40	10 5	13 8	17	0.33 2
110	2501201 1011	110X10.0 SDR11 ISO S-5	110	10	80	38	12 5	15 8	18	0.461
125	2501201 2511	125X11.4 SDR11 ISO S-5	125	11. 4	80	38	13 2	15 8	25	0.513
140	2501201 4011	140X12.7 SDR11 ISO S-5	140	12. 7	92	37	15 5	18 8	25	0.817
160	2501201 6011	160X14.6 SDR11 ISO S-5	160	14. 6	92	38	17 5	21 2	25	1.026

180	2501201 8011	180X16.4 SDR1 1 ISO S-5	180	16. 4	93	43	18 3	21 2	30	1.06
200	2501202 0011	200X18.2 SDR1 1 ISO S-5	200	18. 2	114	40	23 2	26 8	32	2.14
225	2501202 2511	225X20.5 SDR1 1 ISO S-5	225	20. 5	113	52	23 5	26 8	32	2.1
250	2501242 5011	250X22.7 SDR1 1 ISO S-5	250	22. 7	130	58	28 5	32 0	35	3.56
280	2501242 8011	280X25.4 SDR1 1 ISO S-5	280	25. 4	128	58	29 1	32 0	35	3.42
315	2501243 1511	315X28.6 SDR1 1 ISO S-5	315	28. 6	136	65	33 5	37 0	35	5
355	2501203 5511	355X32.2 SDR1 1 ISO S-5	355	32. 2	150	70	37 3	43 0	40	6.88
400	2501204 0011	400X36.3 SDR1 1 ISO S-5	400	36. 3	155	69	42 7	48 2	46	9.04
450	2501244 5011	450X40.9 SDR1 1 ISO S-5	450	40. 9	166	63	51 4	58 5	60	16.22
500	2501205 0011	500X45.4 SDR1 1 ISO S-5	500	45. 4	175	70	53 0	58 5	60	15.76
560	2501245 6011	560X50.8 SDR1 1 ISO S-5	560	50. 8	180	70	61 5	68 5	60	22.78
630	2501206 3011	630X57.2 SDR1 1 ISO S-5	630	57. 2	175	86	64 2	68 5	60	21.84
710	2501207 1011	710X64.5 SDR1 1 ISO S-5	710	64. 5	170	70	73 7	80 0	65	29.4

# Tee

## Agruline

**AGRU Code: 006**

Injection Moulded

Butt Weld

Available in PE100 Black

SDR:33 & 17

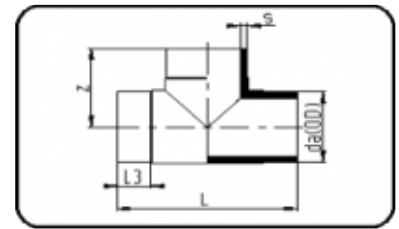

DIMENSI ON	CODE	DETAIL	da(O D) mm	s m m	z mm	m m	L3 m m	WEIGH T
<b>SDR 33</b>								
110	250060110 33	110X3,4 SDR33 ISO S-16	110	3.4	109	22 3	33	0.653
125	250060125 33	125X3,9 SDR33 ISO S-16	125	3.9	115	23 0	40	0.53
140	250060140 33	140X4,3 SDR33 ISO S-16	140	4.3	125	25 3	25	1.08
160	250060160 33	160X4,9 SDR33 ISO S-16	160	4.9	170	34 0	57	1.7
180	250060180 33	180X5,5 SDR33 ISO S-16	180	5.5	182. 5	36 5	57	2.36
200	25006020 033	200X6,2 SDR33 ISO S-16	200	6.2	200	40 0	57	3.14
225	250060225 33	225X6,9 SDR33 ISO S-16	225	6.9	217. 5	43 5	57	4.34
250	250060250 33	250X7,7 SDR33 ISO S-16	250	7.7	237	47 5	70	7.1



280	25006028 033	280X8,6 SDR33 ISO S-16	280	8.6	270	54 0	80	8.45
315	250060315 33	315X9,7 SDR33 ISO S -16	315	9.7	275	55 0	80	11.34
355	250060355 33	355X10,9 SDR33 ISO S-16	355	10. 9	342	68 4	100	16.98
400	25006040 033	400X12,3 SDR33 ISO S-16	400	12. 3	350	70 0	104	23.4
450	25006045 033	450X13,8 SDR33 ISO S-16	450	13. 8	450	90 0	130	33
500	25006050 033	500X15,3 SDR33 ISO S-16	500	15. 3	450	89 5	130	33.5
<b>SDR 17</b>								
63	250060063 17	63X3,8 SDR17 ISO S- 8	63	3.8	72	145	25	0.18
75	250060075 17	75X4,5 SDR17 ISO S- 8	75	4.5	75	150	16	0.322
90	25006009 017	90X5,4 SDR17 ISO S- 8	90	5.4	107	210	38	0.526
110	250060110 17	110X6,6 SDR17 ISO S -8	110	6.6	121	251	50. 5	0.914
125	250060125 17	125X7,4 SDR17 ISO S -8	125	7.4	135	27 0	52	1.38
140	250060140 17	140X8,3 SDR17 ISO S -8	140	8.3	150	30 0	54	1.845
160	250060160 17	160X9,5 SDR17 ISO S -8	160	9.5	170	34 0	57	2.54

180	250060180 17	180X10,7 SDR17 ISO S-8	180	10.7	182. 5	36 5	57	3.52
200	25006020 017	200X11,9 SDR17 ISO S-8	200	11.9	200	40 0	57	4.72
225	250060225 17	225X13,4 SDR17 ISO S-8	225	13. 4	220	44 0	57	6.48
250	250060250 17	250X14,8 SDR17 ISO S-8	250	14. 8	235	46 7	70	8.62
280	25006028 017	280X16,6 SDR17 ISO S-8	280	16. 6	267	53 4	80	12.26
315	250060315 17	315X18,7 SDR17 ISO S-8	315	18.7	275	54 6	80	15
355	250060355 17	355X21,1 SDR17 ISO S-8	355	21.1	340	68 0	104	23.64
400	25006040 017	400X23,7 SDR17 ISO S-8	400	23. 7	345	69 5	104	28.5
450	25006045 017	450X26,7 SDR17 ISO S-8	450	26. 7	445	89 0	130	47.5
500	25006050 017	500x29,7 SDR17 ISO S-8	500	29. 7	445	89 0	130	53.5
<b>SDR 11</b>								
20	25006002 011	20X2,0 SDR11 ISO S- 5	20	2	34	68	17.5	0.013
25	250060025 11	25X2,3 SDR11 ISO S- 5	25	2.3	40	80	20. 5	0.021
32	250060032 11	32X3,0 SDR11 ISO S- 5	32	3	45	90	20. 5	0.039

40	25006004011	40X3,7 SDR11 ISO S-5	40	3.7	50	100	20.5	0.064
50	25006005011	50X4,6 SDR11 ISO S-5	50	4.6	60	120	23	0.122
63	25006006311	63X5,8 SDR11 ISO S-5	63	5.8	72	144	25	0.239
75	25006007511	75X6,8 SDR11 ISO S-5	75	6.8	75	152	15	0.408
90	25006009011	90X8,2 SDR11 ISO S-5	90	8.2	105	212	38	0.701
110	25006011011	110X10,0 SDR11 ISO S-5	110	10	122	253	51	1.24
125	25006012511	125X11,4 SDR11 ISO S-5	125	11.4	140	277	52	1.88
140	25006014011	140X12,7 SDR11 ISO S-5	140	12.7	152	304	53	2.48
160	25006016011	160X14,6 SDR11 ISO S-5	160	14.6	170	340	57	3.44
180	25006018011	180X16,4 SDR11 ISO S-5	180	16.4	182.5	365	57	4.6
200	25006020011	200X18,2 SDR11 ISO S-5	200	18.2	200	400	57	6.32
225	25006022511	225X20,5 SDR11 ISO S-5	225	20.5	220	440	57	8.56
250	25006025011	250X22,7 SDR11 ISO S-5	250	22.7	235	466	72	11.16
280	25006028011	280X25,4 SDR11 ISO S-5	280	25.4	270	536	80	16.2

315	250060315 11	315X28,6 SDR11 ISO S-5	315	28. 6	270	54 0	80	19.7
355	250060355 11	355X32,2 SDR11 ISO S-5	355	32. 2	340	68 0	105	31.32
400	25006040 011	400X36,3 SDR11 ISO S-5	400	36. 3	350	69 5	103	39.3
450	25006045 011	450X40,9 SDR11 ISO S-5	450	40. 9	450	90 0	130	65.52
500	25006050 011	500X45,4 SDR11 ISO S-5	500	45. 4	450	90 0	130	73.72

# Tee Reduced

## Agruline

**AGRU Code: 016**

Injection Moulded

Butt Weld

Available in PE100 Black

SDR: 17 & 11

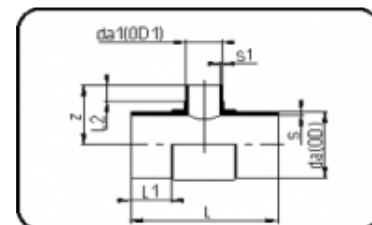

DIMENSION	CODE	DETAIL	da (OD) mm	da1 (OD 1) MM	s m m	Z m m	L m m	L1 m m	L2 m m	s1 m m	WEI GHT
<b>SDR 17</b>											
140/6 3	250161 46317	140/63 SDR 17 ISO S-8	140	63	8. 3	12 0	30 0	86	32	3. 8	1.38
140/75	250161 47517	140/75 SDR 17 ISO S-8	140	75	8. 3	13 0	30 0	86	35	4. 5	1.38

140/90	250161 49017	140/90 SDR 17 ISO S-8	140	90	8. 3	13 0	30 0	86	42	5. 4	1.40 9
140/110	250161 41117	140/110 SDR 17 ISO S-8	140	110	8. 3	13 9	30 0	53	46	6. 6	1.72
160/125	250161 61217	160/125 SD R17 ISO S-8	160	125	9.5	15 0	32 5	62	50	7.4	2.22
180/63	250161 86317	180/63 SDR 17 ISO S-8	180	63	10. 7	13 8	35 8	13 0	32	3. 8	2.18
180/75	250161 87517	180/75 SDR 17 ISO S-8	180	75	10. 7	14 0	36 0	12 0	31	4. 5	2.2
180/110	250161 81117	180/110 SDR 17 ISO S-8	180	110	10. 7	15 2	36 5	10 4	48	6. 6	2.28
180/125	250161 81217	180/125 SD R17 ISO S-8	180	125	10. 7	15 6	35 8	96	52	7.4	2.56
225/125	25016 221217	225/125 SD R17 ISO S-8	225	125	13. 4	18 0	44 5	14 0	45	7.4	4.38
500/200	25016 50201 7	500/200 SD R17 ISO S-8	500	200	29. 7	40 5	90 0	13 3	11 5	11. 9	48.7 4
<b>SDR 11</b>											
90/32	25016 903211	90/32 SDR1 1 ISO S-5	90	32	8. 2	85	21 3	57	23	3	0.57 9
90/50	25016 905011	90/50 SDR1 1 ISO S-5	90	50	8. 2	90	21 0	57	27	4. 6	0.58 9
110/32	250161 13211	110/32 SDR1 1 ISO S-5	110	32	10	94	24 0	70	23	3	0.96 3
110/50	250161 15011	110/50 SDR1 1 ISO S-5	110	50	10	10 0	24 0	70	27	4. 6	0.96 5

125/63	250161 26311	125/63 SDR1 1 ISO S-5	125	63	11. 4	11 2	27 5	75	31	5. 8	1.42
140/63	250161 46311	140/63 SDR 11 ISO S-5	140	63	12. 7	12 0	30 2	87	32	5. 8	1.88
140/75	250161 47511	140/75 SDR 11 ISO S-5	140	75	12. 7	13 0	30 2	87	35	6. 8	1.85
140/90	250161 49011	140/90 SDR 11 ISO S-5	140	90	12. 7	13 0	30 5	88	42	8. 2	1.967
140/110	250161 41111	140/110 SDR 11 ISO S-5	140	110	12. 7	14 1	30 5	54	47	10	2.28
160/125	250161 61211	160/125 SD R11 ISO S-5	160	125	14. 6	15 0	32 5	62	52	11. 4	2.82
180/63	250161 86311	180/63 SDR 11 ISO S-5	180	63	16. 4	13 9	35 8	13 2	32	5. 8	3.16
180/75	250161 87511	180/75 SDR 11 ISO S-5	180	75	16. 4	14 4	36 2	11 9	31	6. 8	3.18
180/125	250161 81211	180/125 SD R11 ISO S-5	180	125	16. 4	16 6	36 2	10 0	52	11. 4	3.36
225/125	25016 221211	225/125 SD R11 ISO S-5	225	125	20. 5	17 8	45 6	14 3	45	11. 4	6.4
500/200	25016 502011	500/200 SD R11 ISO S-5	500	200	45. 4	40 5	90 0	13 0	11 5	18. 2	64

# Union Type 24

Agruline

**AGRU Code: 024**

FPM Sealing, Injection Moulded

Butt Weld

Available in PE100 Black

SDR 11

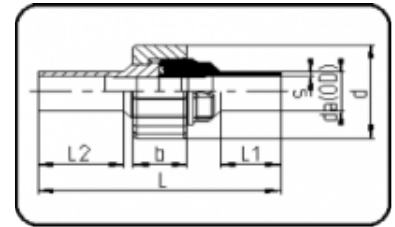

DIMENSION	CODE	DETAIL	da(OD) mm	s mm	L mm	L1 mm	L2 mm	d mm	b mm	WEIGHT HT
<b>SDR 11</b>										
20	2502401 2011	20 SDR11 IS O S-5	20	2	108	24	38	47	24	0.049
25	2502401 2511	25 SDR11 IS O S-5	25	2.3	114	24	39	57	26	0.08
32	2502401 3211	32 SDR11 IS O S-5	32	3	122	25	39	64	30	0.106
40	2502401 4011	40 SDR11 IS O S-5	40	3.7	128	25	42	78	31	0.178
50	2502401 5011	50 SDR11 IS O S-5	50	4.6	134	25	44	89	35	0.24
63	2502401 6311	63 SDR11 IS O S-5	63	5.8	138	25	44	109	39	0.39

**Renowned Supplier of High Quality Plastic Products**